



The Creek, TW16

£875,000



Offers In Excess Of. A unique family home set in idyllic rural location close to the Thames with Egyptian design influence present as a theme

Accommodation is made up of a dining room with domed ceiling, kitchen, spacious living room with feature fire place and triple aspect windows overlooking a lush tropical garden and doors to outdoor balcony. There are three bedrooms on this level as well as an exotically designed bathroom and further W.C.

On the lower ground floor is a large study/ bedroom 4 and utility room.

The Creek is a riverside road located off Fordbridge Road. The local village shops, Sunbury Park and the riverside pubs are just over half a mile away.

Features

Unique Family Home
Three Bedrooms
Beautiful Gardens
Great for Entertaining
Garage and Parking
Great Views



The Creek, Sunbury-On-Thames, TW16

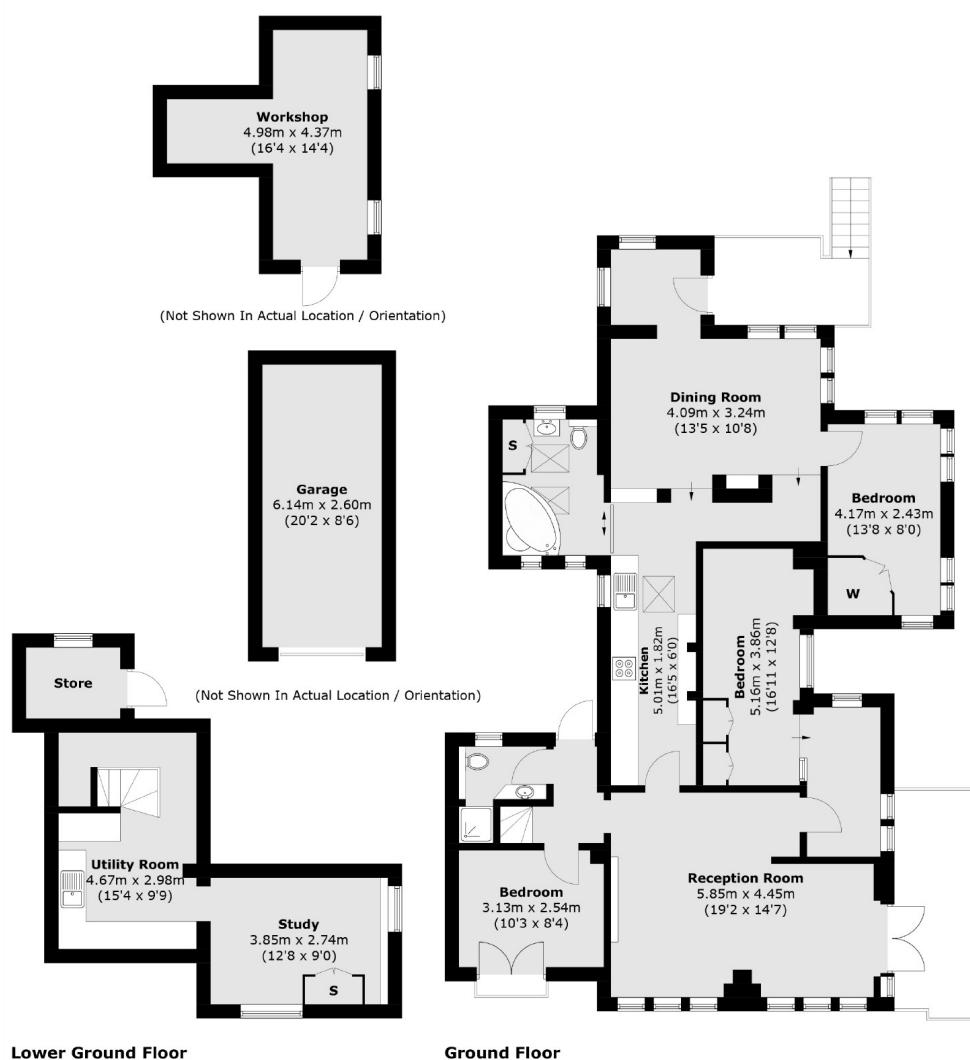

Total area (approx.): 139.3 sq. m (1,499.3 sq. ft)
 Garage / Workshop area: 29.6 sq. m (318.6 sq. ft)
 External areas: 16.7 sq. m (179.7 sq. ft)

Contact

To arrange a viewing call our office on the number below or visit our website.



Energy Rating: E. We aim to make our particulars both accurate and reliable. However they are not guaranteed; nor do they form part of an offer or contract. If you require clarification on any points then please contact us, especially if you're traveling some distance to view. Please note that appliances and heating systems have not been tested and therefore no warranties can be given as to their good working order.