

FLETCHERS

ESTATE AGENTS



Wolseley Gardens, W4

£2,077 Per week (£9,000 pcm)

Wolseley Gardens is located in the popular Grove Park area of Chiswick and only a short walk to Gunnersbury Tube Station and from Chiswick Overground.

- Five Bedrooms • Three Bathrooms • Recently Refurbished • Wooden Flooring • Eat-in Kitchen • Grove Park Location •

FLETCHERS

ESTATE AGENTS

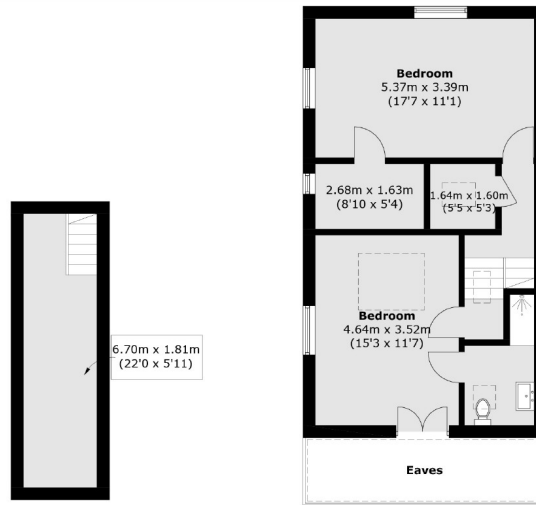

Basement

Second Floor



Ground Floor

First Floor

Total area (approx.): 233.2 sq. m (2510.0 sq. ft)
(Including Basement / Excluding Eaves)

Fletchers Chiswick High Road Lettings
86 Chiswick High Road, Chiswick, London, W4 1SY
020 8742 4100
chiswicklettings@fletcherstates.com

Energy Rating: C. We aim to make our particulars both accurate and reliable. However they are not guaranteed; nor do they form part of an offer or contract. If you require clarification on any points then please contact us, especially if you're traveling some distance to view. Please note that appliances and heating systems have not been tested and therefore no warranties can be given as to their good working order.