

# FLETCHERS

ESTATE AGENTS



**Chiswick High Road, W4**

**£519 Per week (£2400 pcm)**

A two double bedroom garden flat with large open plan kitchen/reception room with doors opening out onto a secluded garden.

Located on Chiswick High Road close to Gunnersbury underground station and providing easy access in and out of London via the A4/M4.

- Two Double Bedrooms • Garden Flat • Open Plan Living • Modern Shower Room • Near Underground Station • Chiswick High Road •

# FLETCHERS

ESTATE AGENTS

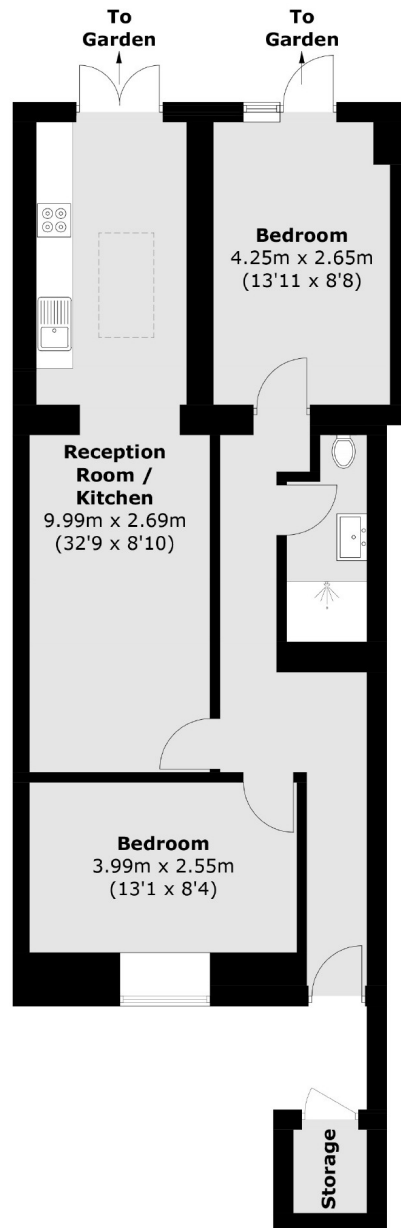

Total area (approx.): 64.7 sq. m (696.4 sq. ft)  
Storage: 1.5 sq. m (16 sq. ft)

Fletchers Chiswick High Road Lettings  
86 Chiswick High Road, Chiswick, London, W4 1SY  
020 8742 4100  
[chiswicklettings@fletcherstates.com](mailto:chiswicklettings@fletcherstates.com)

Energy Rating: D. We aim to make our particulars both accurate and reliable. However they are not guaranteed; nor do they form part of an offer or contract. If you require clarification on any points then please contact us, especially if you're traveling some distance to view. Please note that appliances and heating systems have not been tested and therefore no warranties can be given as to their good working order.