

FLETCHERS

ESTATE AGENTS



Oxford Gardens, W4

£449,950

This two bedroom flat is on the ground floor of a Victorian mid terraced house, and benefits from a decent private garden and a share of the freehold.

Well located near the Thames Riverside part of Chiswick, including the popular cafés along Strand on the Green. A short walk North is Chiswick High Road and Gunnersbury underground station. There is easy access to the M4/A4.

- Two Bedrooms • Private Garden • Share of Freehold • Open Plan Living Room • Chiswick Riverside • Gunnersbury Station •

FLETCHERS

ESTATE AGENTS

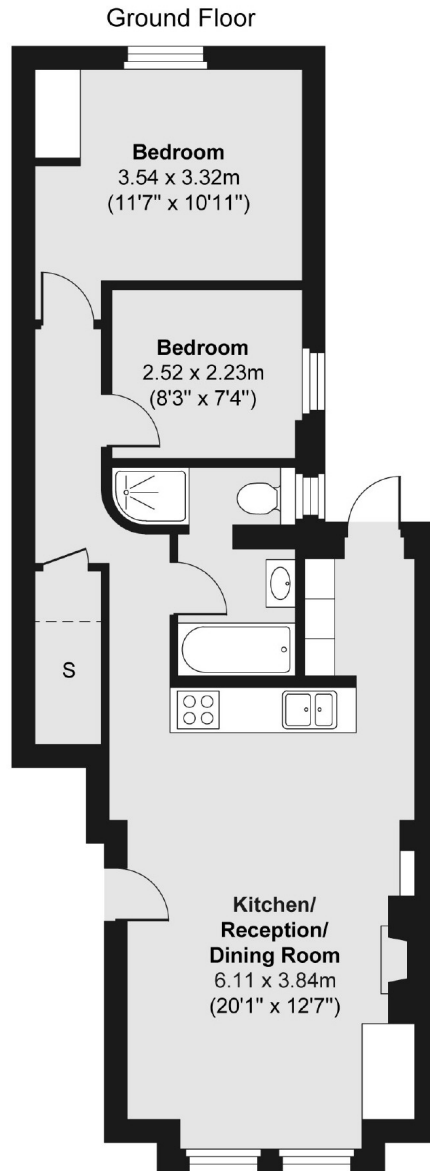

Total area (approx.) 55.46 sq. m (597 sq. ft)

Fletchers Chiswick Turnham Green Sales
58 Turnham Green Terrace, London, W4 1QP
020 8987 3000
chiswicksales@fletcherestates.com

Energy Rating: D. We aim to make our particulars both accurate and reliable. However they are not guaranteed; nor do they form part of an offer or contract. If you require clarification on any points then please contact us, especially if you're traveling some distance to view. Please note that appliances and heating systems have not been tested and therefore no warranties can be given as to their good working order.