

FLETCHERS

ESTATE AGENTS



Fielding Road, W4

£1,450,000

An end of terrace home in Bedford park uniquely wider than the average house with a beautiful sunny garden. Offering three bedrooms, two bathrooms with tons of potential to extend on both the ground floor and into the loft.

Fielding Road is a calm residential turning within easy reach of the wonderful array of shops, boutiques and restaurants on Chiswick High Road, with Turnham Green station and numerous bus routes also easily accessible.

- End of Terrace • Bedford Park • Rear and Side Access • Potential To Extend • Period Features • No Onward Chain •

FLETCHERS

ESTATE AGENTS

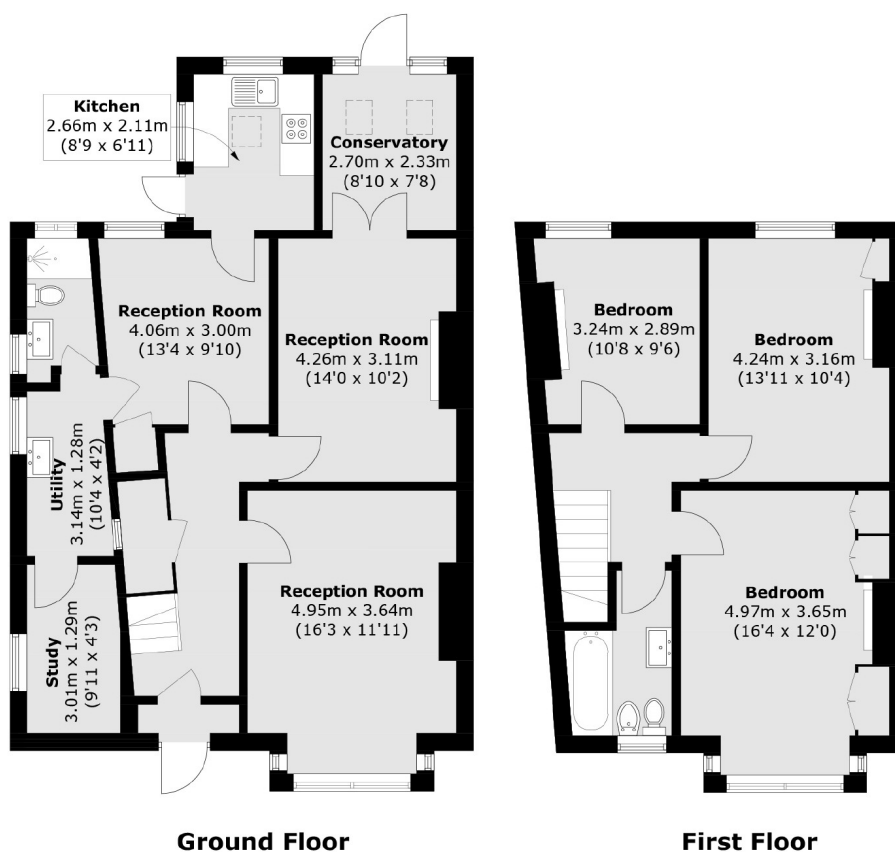

Total area (approx.): 132.3 sq. m (1,424.1 sq. ft)

Fletchers Chiswick Turnham Green Sales
58 Turnham Green Terrace, London, W4 1QP
020 8987 3000
chiswicksales@fletcherestates.com

Energy Rating: C. We aim to make our particulars both accurate and reliable. However they are not guaranteed; nor do they form part of an offer or contract. If you require clarification on any points then please contact us, especially if you're traveling some distance to view. Please note that appliances and heating systems have not been tested and therefore no warranties can be given as to their good working order.