

# FLETCHERS

ESTATE AGENTS

---



## Bolton Road, W4

£650,000

A luxury one bedroom apartment on the raised ground floor of a stunning mansion house, with a spacious detached garage included and access to shared gardens.





The property has original coving and panelling in fantastic condition, wood flooring, a large bay window brings in plenty of natural light to the reception room. A separate kitchen has its own private side entrance, and the bedroom has bespoke floor to ceiling built in wardrobes.

Bolton Road is in the heart of Grove Park, with Riverside, Strand on the Green and Chiswick House all nearby. Chiswick Station within a short walk, offering a 25 minute line to London Waterloo and the A4/M4 offers easy access into and out of London by car.

- Raised Ground Floor • Private Entrance • Original Features •
- High Ceilings • Large Garage • Shared Gardens •







# FLETCHERS

ESTATE AGENTS

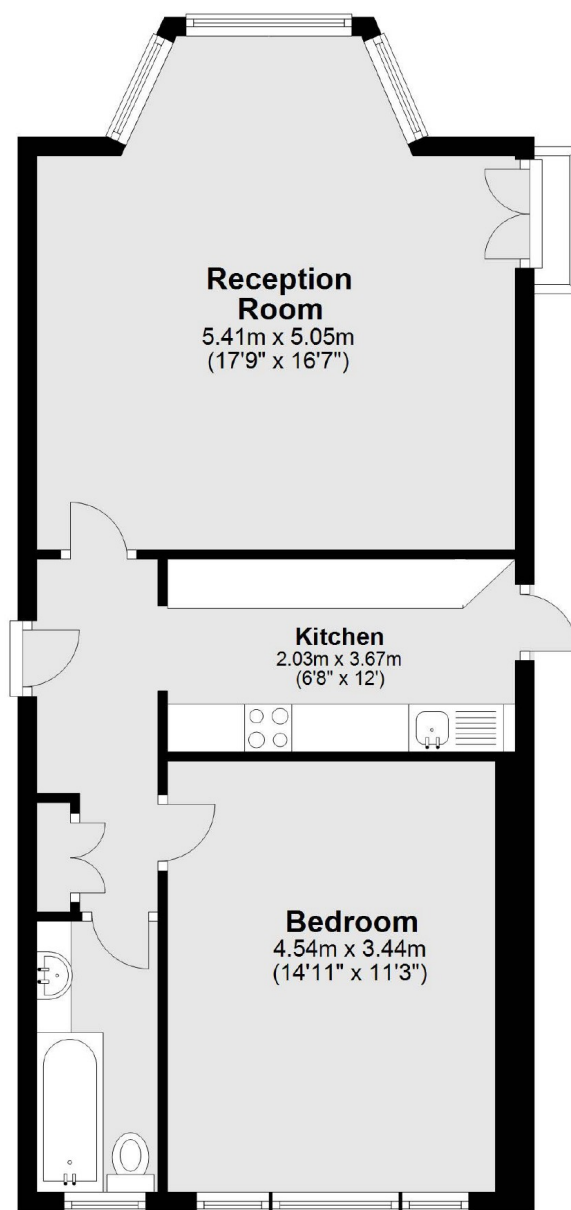

Total area: approx. 58.3 sq. metres (627.8 sq. feet)

Fletchers Chiswick Turnham Green Sales  
58 Turnham Green Terrace  
London  
W4 1QP  
020 8987 3000  
[chiswicksales@fletcherestates.com](mailto:chiswicksales@fletcherestates.com)

Energy Rating: C We aim to make our particulars both accurate and reliable. However they are not guaranteed; nor do they form part of an offer or contract. If you require clarification on any points then please contact us, especially if you're traveling some distance to view. Please note that appliances and heating systems have not been tested and therefore no warranties can be given as to their good working order