

FLETCHERS

ESTATE AGENTS



Graham Road, W4

£495,000

A beautiful ground floor one bedroom garden apartment in a peaceful residential enclave in Chiswick between Southfield Road and Acton Lane. Renovated by the current owners retaining some lovely original details, including exposed timber floors and benefits from direct access to it's own sunny south facing garden.

Graham Road is a lovely tree lined residential turning within easy reach of the wonderful array of shops, boutiques and restaurants on Chiswick High Road, with Turnham Green station and numerous bus routes also easily accessible.

- Private Entrance • Bay Fronted Reception Room • Renovated Kitchen • South Facing Garden • Original Features • Tree Lined Street •

FLETCHERS

ESTATE AGENTS

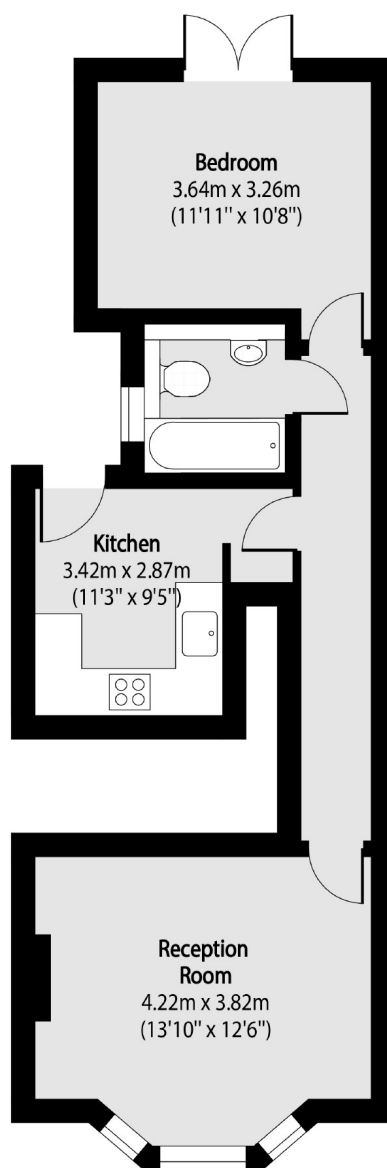

Total area (approx): 43.74 sq m (471 sq. ft)

Fletchers Chiswick Turnham Green Sales
58 Turnham Green Terrace, London, W4 1QP
020 8987 3000
chiswicksales@fletcherestates.com

Energy Rating: D. We aim to make our particulars both accurate and reliable. However they are not guaranteed; nor do they form part of an offer or contract. If you require clarification on any points then please contact us, especially if you're traveling some distance to view. Please note that appliances and heating systems have not been tested and therefore no warranties can be given as to their good working order.