

FLETCHERS

ESTATE AGENTS



Heathfield Terrace, W4

£435,000

A fourth floor, one bedroom apartment with far reaching views benefitting from a separate kitchen and a spacious reception room with large windows overlooking Turnham Green. The building is well looked after and includes lift access, secure entry system and off street parking. A private garage is also included. The service charges include heating/hot water.

Heathfield Court is a very well managed and maintained apartment block, in a prime location only moments from the wonderful array of High Street brands, restaurants, boutiques and supermarkets on Chiswick High Road, and has easy access to either Chiswick Park or Turnham Green stations.

• One Bedroom • Fourth Floor • Garage • Off Street Parking • Lift Access • Share of

FLETCHERS

ESTATE AGENTS

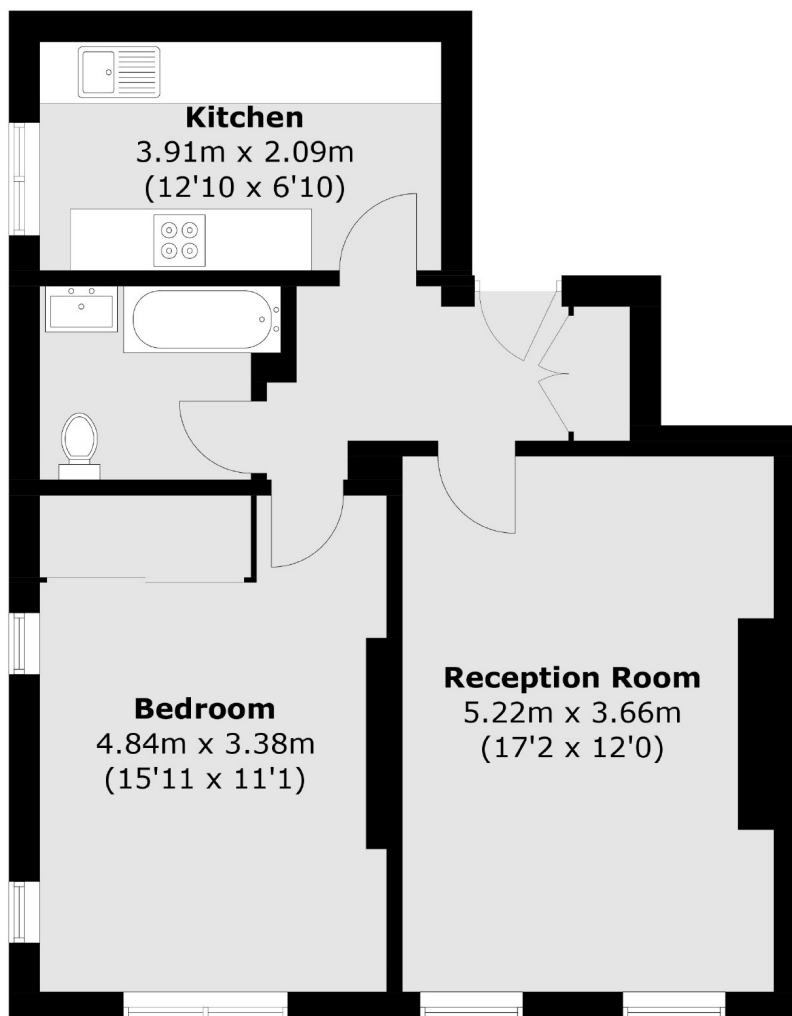

Total area (approx.): 55.9 sq. m (601.7 sq. ft)

Fletchers Chiswick Turnham Green Sales
58 Turnham Green Terrace, London, W4 1QP
020 8987 3000
chiswicksales@fletcherestates.com

Energy Rating: C. We aim to make our particulars both accurate and reliable. However they are not guaranteed; nor do they form part of an offer or contract. If you require clarification on any points then please contact us, especially if you're traveling some distance to view. Please note that appliances and heating systems have not been tested and therefore no warranties can be given as to their good working order.