

FLETCHERS

ESTATE AGENTS



Boddington Gardens, W3

£475,000

A spacious two bedroom apartment in a modern build block. The flat has been upgraded and decorated in a homely way throughout and includes a separate kitchen, plenty of built in storage and a large reception / dining area with bay window. There is a private off street parking space included and access to communal gardens.

Boddington Gardens is a quiet, residential cul-de-sac within easy reach of Acton, Ealing and Chiswick. A residents only footpath with secure fob entry allows direct access to Acton Town station (Piccadilly and District Line). Gunnersbury Park is within 0.5m walk.

• Modern Block • Two Bedrooms • Separate Kitchen • Built in Storage • Private Parking • Communal Gardens •

FLETCHERS

ESTATE AGENTS

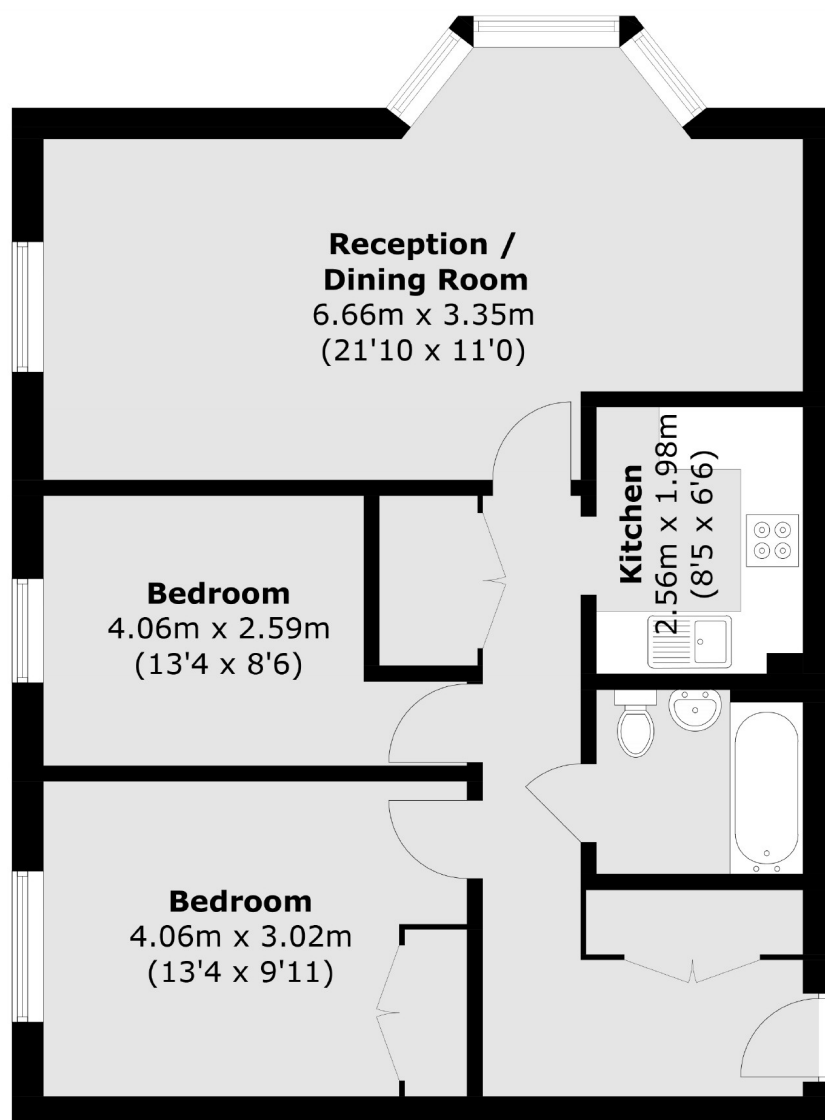

Total area (approx.): 68.8 sq. m (740.5 sq. ft)

Fletchers Chiswick Turnham Green Sales
58 Turnham Green Terrace, London, W4 1QP
020 8987 3000
chiswicksales@fletcherestates.com

Energy Rating: B. We aim to make our particulars both accurate and reliable. However they are not guaranteed; nor do they form part of an offer or contract. If you require clarification on any points then please contact us, especially if you're traveling some distance to view. Please note that appliances and heating systems have not been tested and therefore no warranties can be given as to their good working order.