



Anstice Close, W4

£340,000

A light and airy second floor one bedroom flat in a purpose-built development in this calm residential enclave. The flat features a sunny dual-aspect reception room and unallocated off-street parking.

Anstice Close is a peaceful purpose built development alongside the River Thames within a quarter of a mile of the A316 and A4 and within half a mile of Chiswick overground station.

- Double Bedroom • Purpose Built Development • Fitted Wardrobes • Additional Storage • Off-Street Parking • Chain Free •

FLETCHERS

ESTATE AGENTS

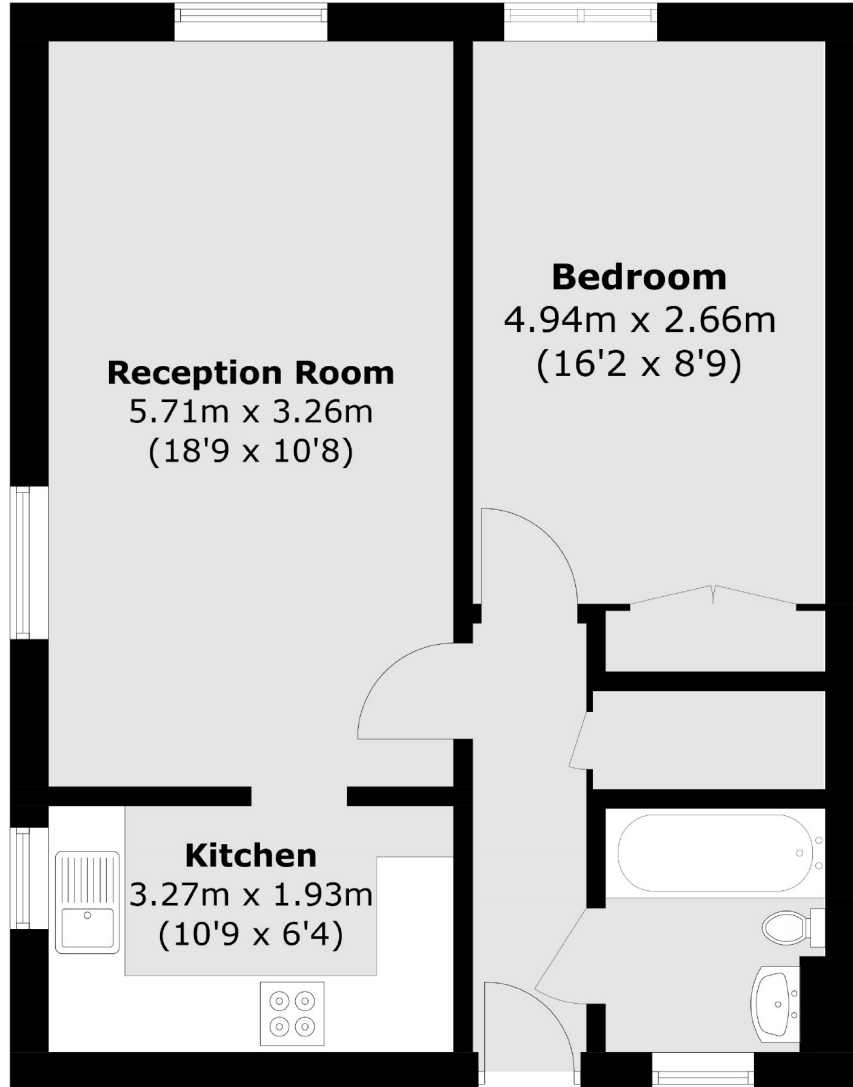

Total area (approx.): 48.2 sq. m (518.8 sq. ft)

Fletchers Chiswick Turnham Green Sales
58 Turnham Green Terrace, London, W4 1QP
020 8987 3000
chiswicksales@fletcherestates.com

Energy Rating: C. We aim to make our particulars both accurate and reliable. However they are not guaranteed; nor do they form part of an offer or contract. If you require clarification on any points then please contact us, especially if you're traveling some distance to view. Please note that appliances and heating systems have not been tested and therefore no warranties can be given as to their good working order.