

FLETCHERS

ESTATE AGENTS



Beverley Road, W4

£785,000

A brilliantly located ground floor garden flat within an attractive semi detached home. With two double bedrooms, a separate kitchen, reception room and conservatory which leads out to a spacious South facing private garden. There is exciting potential to extend on both sides of the property to take advantage of the full width of the plot and the front garden has potential to be converted into a parking space (subject to consent).

Beverley Road is a popular, quiet residential road consisting of beautiful family homes. Chiswick High Road and Turnham Green are just a short walk offering a superb selection of shops, cafés and restaurants as well as both Stamford Brook and Turnham Green tube station.

- Ground Floor Flat • Two Bedrooms • South Facing Garden • Utility Room • Side Access • Potential to Extend •

FLETCHERS

ESTATE AGENTS

Ground Floor

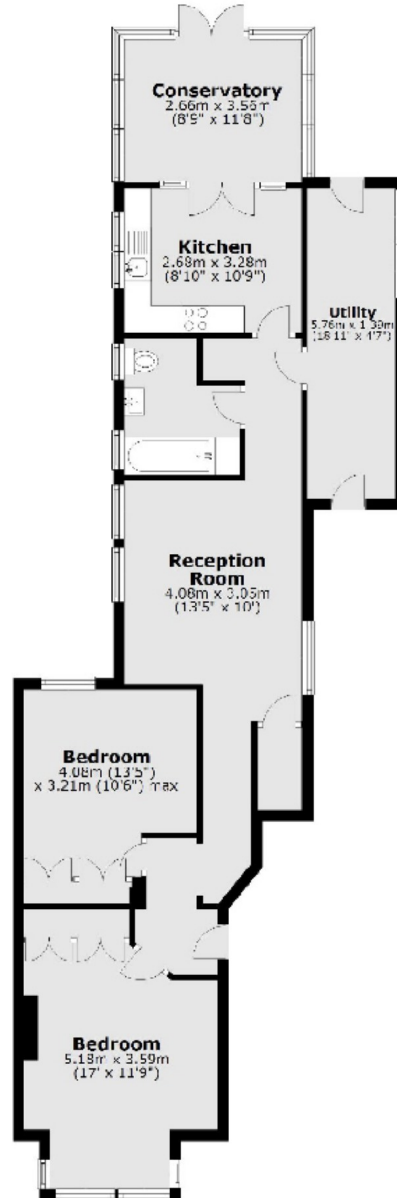

Total area: approx. 85.6 sq. metres (921.3 sq. feet)

Fletchers Chiswick Turnham Green Sales
58 Turnham Green Terrace, London, W4 1QP
020 8987 3000
chiswicksales@fletcherestates.com

Energy Rating: E. We aim to make our particulars both accurate and reliable. However they are not guaranteed; nor do they form part of an offer or contract. If you require clarification on any points then please contact us, especially if you're traveling some distance to view. Please note that appliances and heating systems have not been tested and therefore no warranties can be given as to their good working order.