

FLETCHERS

ESTATE AGENTS



Weston Road, W4

£550,000

In this peaceful enclave close to Chiswick Park Station. A well proportioned level ground floor garden flat, with lovely entertaining areas leading directly to a secluded rear garden.

Weston Road is within walking distance of Chiswick Park station and the large Sainsburys supermarket, with the wonderful selection of Boutiques and shops on Chiswick High Road just beyond.

- Two Double Bedrooms • Open Plan Kitchen/Living Room • Private Garden • Double Gazed Windows • No Onward Chain • Chiswick Park Station •

FLETCHERS

ESTATE AGENTS

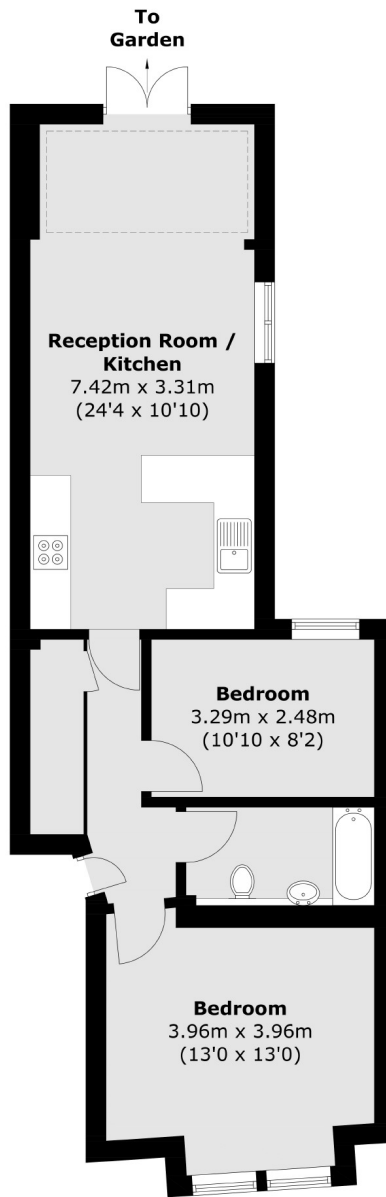

Total area (approx.): 58.7 sq. m (631.8 sq. ft)

Fletchers Chiswick Turnham Green Sales
58 Turnham Green Terrace, London, W4 1QP
020 8987 3000
chiswicksales@fletcherestates.com

Energy Rating: D. We aim to make our particulars both accurate and reliable. However they are not guaranteed; nor do they form part of an offer or contract. If you require clarification on any points then please contact us, especially if you're traveling some distance to view. Please note that appliances and heating systems have not been tested and therefore no warranties can be given as to their good working order.