



Heathfield Terrace, W4

£425,000

A spacious one bedroom flat on the top floor of the popular and extremely well run Heathfield Court development, with lift access and plenty of storage throughout. Benefitting from great natural light from south and west-facing windows.

A fantastic location overlooking Turnham Green, with an array of shops, restaurants and cafés available on Chiswick High Road, as well as Chiswick Park station.

- One Bedroom • Fifth Floor • Lift Access • Separate Kitchen • Video Entry System • Share of Freehold •

Fifth Floor

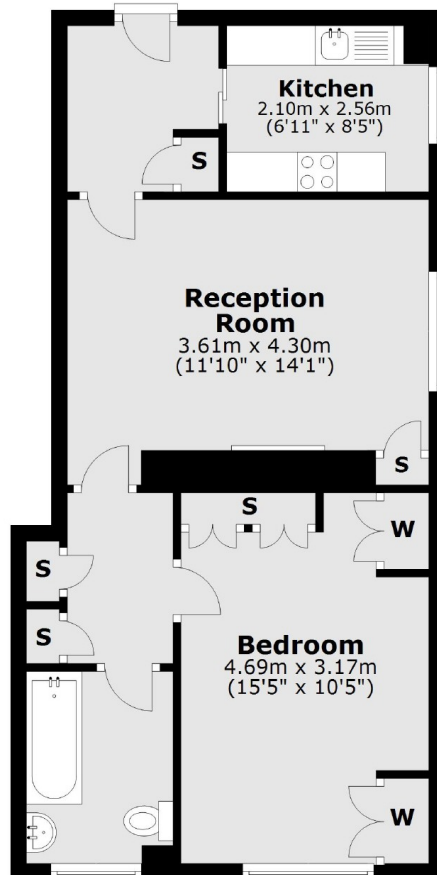

Total area: approx. 50.6 sq. metres (545.2 sq. feet)

Fletchers Chiswick Turnham Green Sales
58 Turnham Green Terrace, London, W4 1QP
020 8987 3000
chiswicksales@fletcherestates.com

Energy Rating: E. We aim to make our particulars both accurate and reliable. However they are not guaranteed; nor do they form part of an offer or contract. If you require clarification on any points then please contact us, especially if you're traveling some distance to view. Please note that appliances and heating systems have not been tested and therefore no warranties can be given as to their good working order.