

FLETCHERS

ESTATE AGENTS



Priory Road, W4

£1,050,000

A well presented three bedroom period home with a double reception room, potential for a side return and the loft already extended. This home is ready to move into with a secluded west facing garden.

Priory Road is ideally situated on a quiet cul de sac near the open spaces of Acton Green and is approximately a quarter of a mile from Turnham Green and Chiswick Park Tubes. The property also provides easy access in and out of London via the A4.

- Three Bedroom • Two Bathrooms • West Facing Garden • Ample Storage • Converted Loft • Residents Parking •

FLETCHERS

ESTATE AGENTS

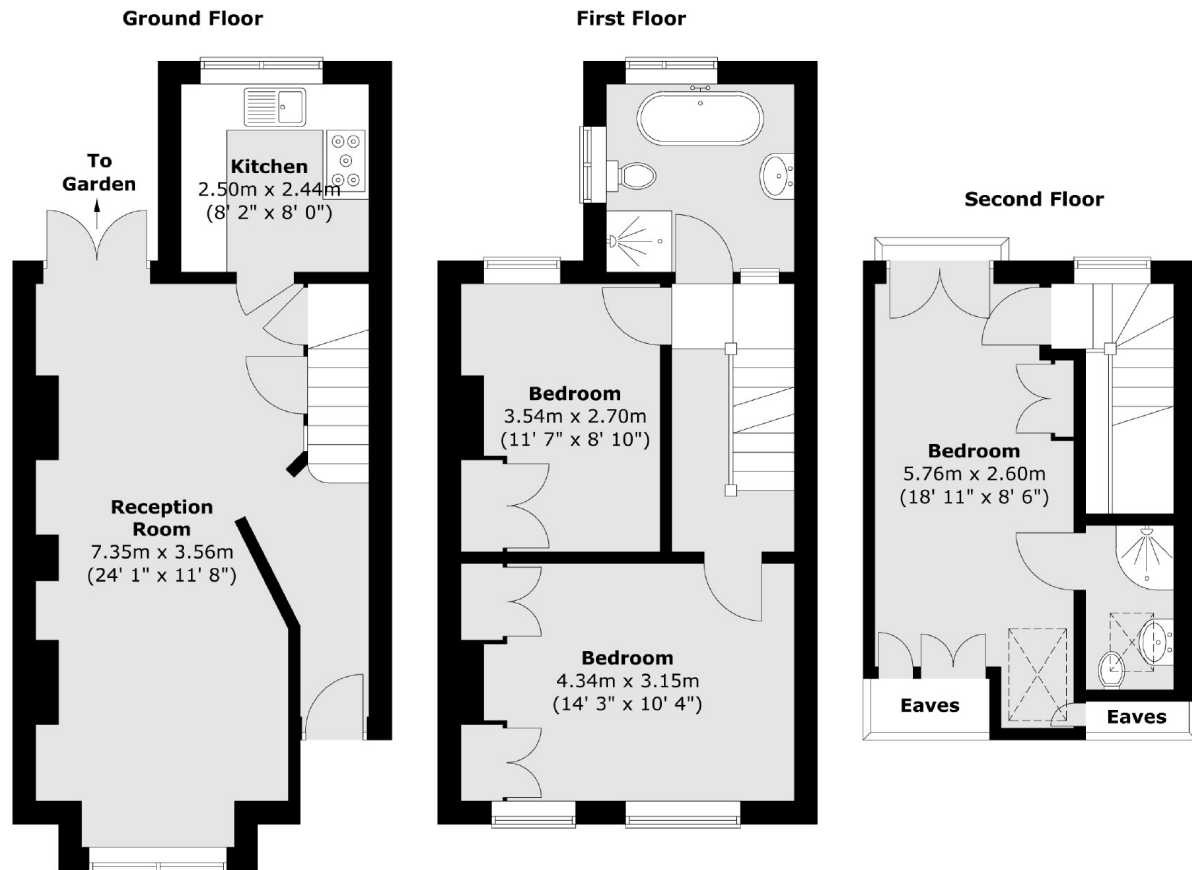

Total area (approx.) : 92.9 sq. m (1000 sq. ft)
(Excluding Eaves)

Fletchers Chiswick Turnham Green Sales
58 Turnham Green Terrace, London, W4 1QP
020 8987 3000
chiswicksales@fletcherestates.com

Energy Rating: C. We aim to make our particulars both accurate and reliable. However they are not guaranteed; nor do they form part of an offer or contract. If you require clarification on any points then please contact us, especially if you're traveling some distance to view. Please note that appliances and heating systems have not been tested and therefore no warranties can be given as to their good working order.