

FLETCHERS

ESTATE AGENTS



Esmond Gardens, W4

£700,000

A two bedroom apartment on the ground floor of a popular, centrally located mansion block. Retains plenty of character and includes a large reception room, separate eat-in kitchen and access to a shared garden.

South Parade is ideally located by Turnham Green Terrace and the popular Bedford Park area. Overlooking Acton Green, with a very short walk taking you to Chiswick High Road and plenty of local amenities.

- Offers In Excess Of
- Ground Floor
- Eat-in Kitchen
- Large Reception Room
- Share of Freehold
- Reserved Off Street Parking

FLETCHERS

ESTATE AGENTS

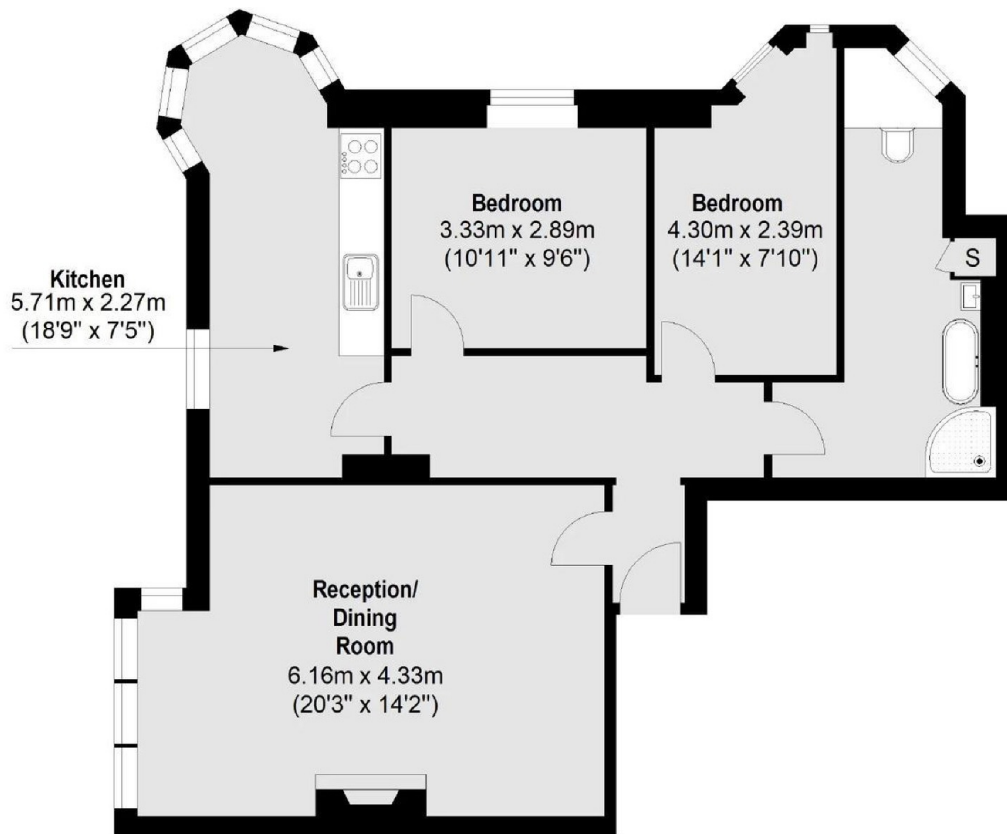

Internal Area (approx.): 78.6 sq. m (846.1 sq. ft)

Fletchers Chiswick Turnham Green Sales
58 Turnham Green Terrace, London, W4 1QP
020 8987 3000
chiswicksales@fletcherestates.com

Energy Rating: D. We aim to make our particulars both accurate and reliable. However they are not guaranteed; nor do they form part of an offer or contract. If you require clarification on any points then please contact us, especially if you're traveling some distance to view. Please note that appliances and heating systems have not been tested and therefore no warranties can be given as to their good working order.