

SNELLERS

ESTATE AGENTS



Wiltshire Gardens, TW2

£675,000

This well presented three bedroom home is offered to the market with no onward chain and offers exciting potential for modernisation and extending. Located on a popular road, this property further benefits from a sunny garden, garage and off street parking.

In an ideal location, Wiltshire Gardens is just 0.6 miles from Whitton Station and within easy reach of several bus routes. Kneller Gardens is only 0.3 miles away, providing open green space, a playground, tennis courts and riverside walks, perfect for families and nature lovers alike.

- Three Bedrooms • No Onward Chain • Off Street Parking •
- South Facing Garden • Potential To Extend • Popular Location •

SNELLERS

ESTATE AGENTS

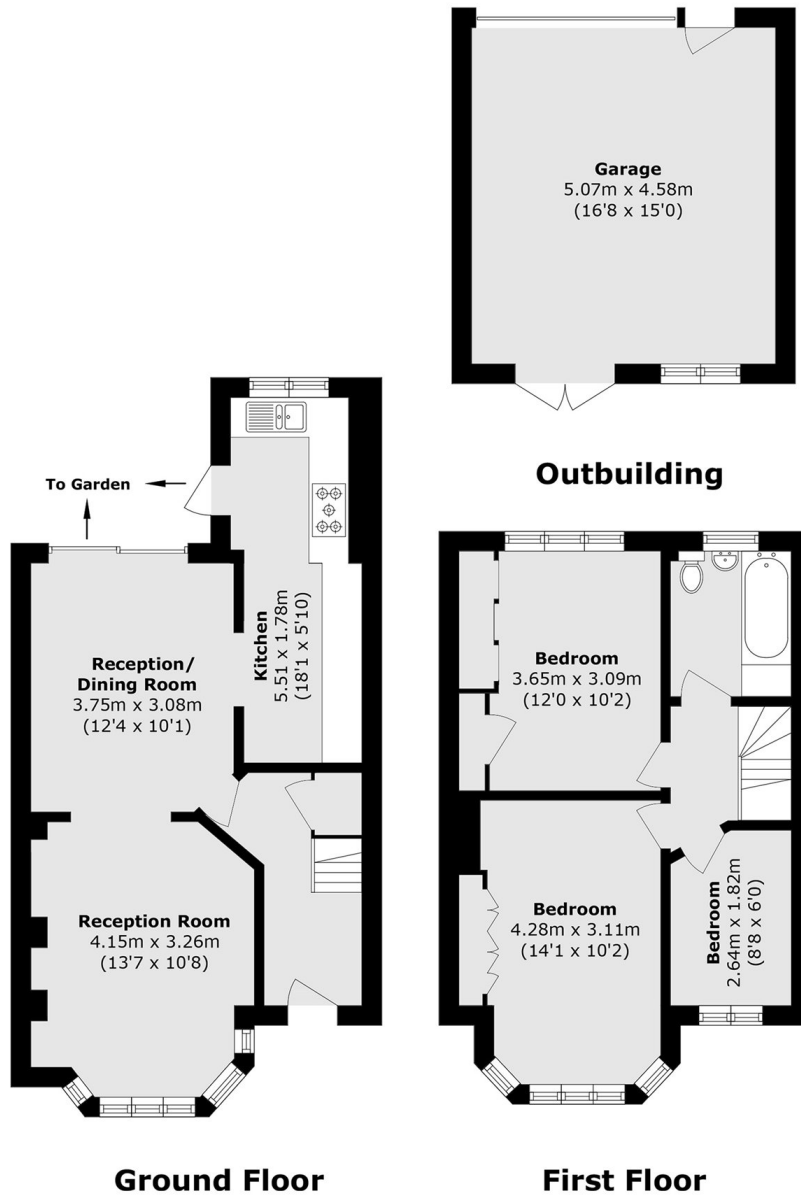

Total area (approx.): 79.2 sq. m (852.5 sq. ft)
(Excluding Garage)
Garage area (approx.): 23.2 sq. m (249.7 sq. ft)

Snellers Twickenham Sales
64-66 Heath Road
Twickenham
TW1 4BX
020 8892 5555
twickenhamsales@snellers.co.uk

Energy Rating: D We aim to make our particulars both accurate and reliable. However they are not guaranteed; nor do they form part of an offer or contract. If you require clarification on any points then please contact us, especially if you're traveling some distance to view. Please note that appliances and heating systems have not been tested and therefore no warranties can be given as to their good working order