

SNELLERS

ESTATE AGENTS



Swan Island, TW1

£150,000

A unique opportunity to purchase this charming one-bedroom houseboat moored on Swan Island. Features an open-plan kitchen and living space with a log-burning fireplace, modern bathroom and reinforced roof with river views.

Set by a peaceful riverside, it is located just a short walk to local shops, cafes, and Strawberry Hill station.

- Houseboat • Open Plan • Log-Burning Fireplace •
- Well Presented • Reinforced Roof Space • Modern •

SNELLERS

ESTATE AGENTS

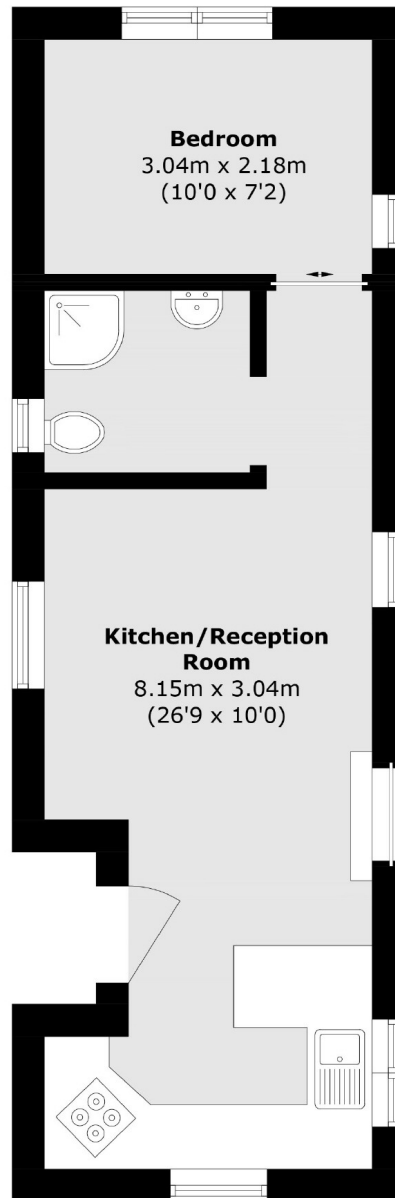

Total area (approx.): 30.2 sq. m (325.0 sq. ft)

Snellers Twickenham Sales
64-66 Heath Road
Twickenham
TW1 4BX
020 8892 5555
twickenhamsales@snellers.co.uk

Energy Rating: We aim to make our particulars both accurate and reliable. However they are not guaranteed; nor do they form part of an offer or contract. If you require clarification on any points then please contact us, especially if you're traveling some distance to view. Please note that appliances and heating systems have not been tested and therefore no warranties can be given as to their good working order