



Strawberry Hill Road, TW1

£399,950

Offered to the market with no onward chain and a newly extended lease upon completion, stands this propose built two bedroom apartment located in the heart of Strawberry Hill. Further benefits include allocated covered parking and communal gardens.

Set in one of the area's most prestigious roads, Mulberry Court is moments from local amenities and Strawberry Hill Station. At the other end of the road are local bus-routes. Radnor Gardens is just half a mile away and Twickenham town centre and Green is also reached easily.

- No Onward Chain • Two Bedrooms • First Floor •
- Central Location • Allocated Parking • Extended Lease •

SNELLERS

ESTATE AGENTS

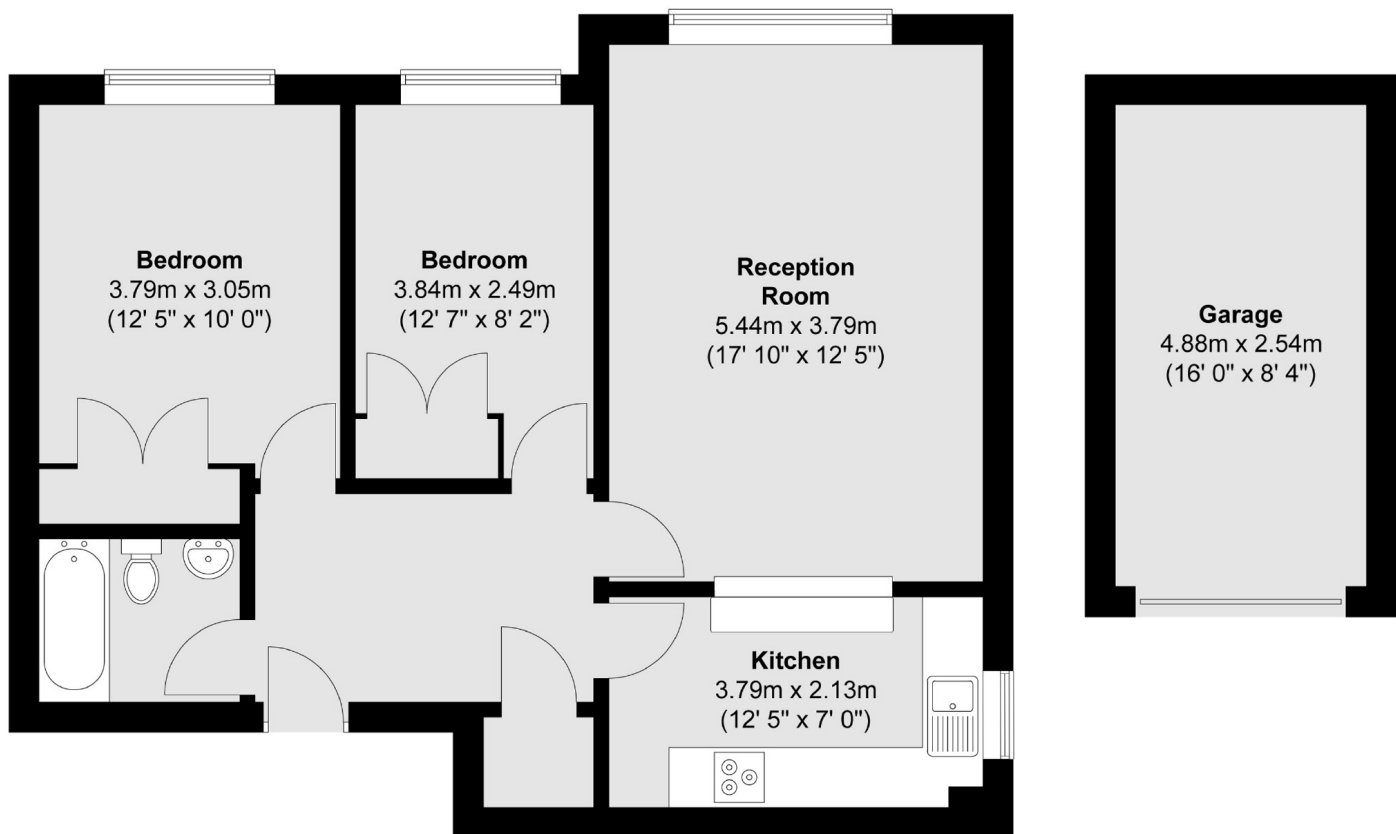

Total area (approx.) : 65.6 sq. m (706 sq. ft)
Total garage area (approx.) : 12.4 sq. m (133 sq. ft)

Snellers Twickenham Sales
64-66 Heath Road
Twickenham
TW1 4BX
020 8892 5555
twickenhamsales@snellers.co.uk

Energy Rating: D We aim to make our particulars both accurate and reliable. However they are not guaranteed; nor do they form part of an offer or contract. If you require clarification on any points then please contact us, especially if you're traveling some distance to view. Please note that appliances and heating systems have not been tested and therefore no warranties can be given as to their good working order