

SNELLERS

ESTATE AGENTS



Manor Road, TW2

£1,950 PCM

Overlooking beautiful parklands and in a quiet residential area is this large two double bedroom ground floor maisonette. The property is in excellent condition which includes a separate kitchen. There is also a large living/dining room which opens on to a private garden, lots of storage, easy parking and a garage.

Manor Road is a quiet residential street close to the River Crane and within walking distance of Twickenham Green and Twickenham high street, and has easy access to the A316 into central London

- Ground Floor Flat • Two Double Bedrooms • Private Garden •
- Separate Kitchen • Garage • Gated Development •

SNELLERS

ESTATE AGENTS

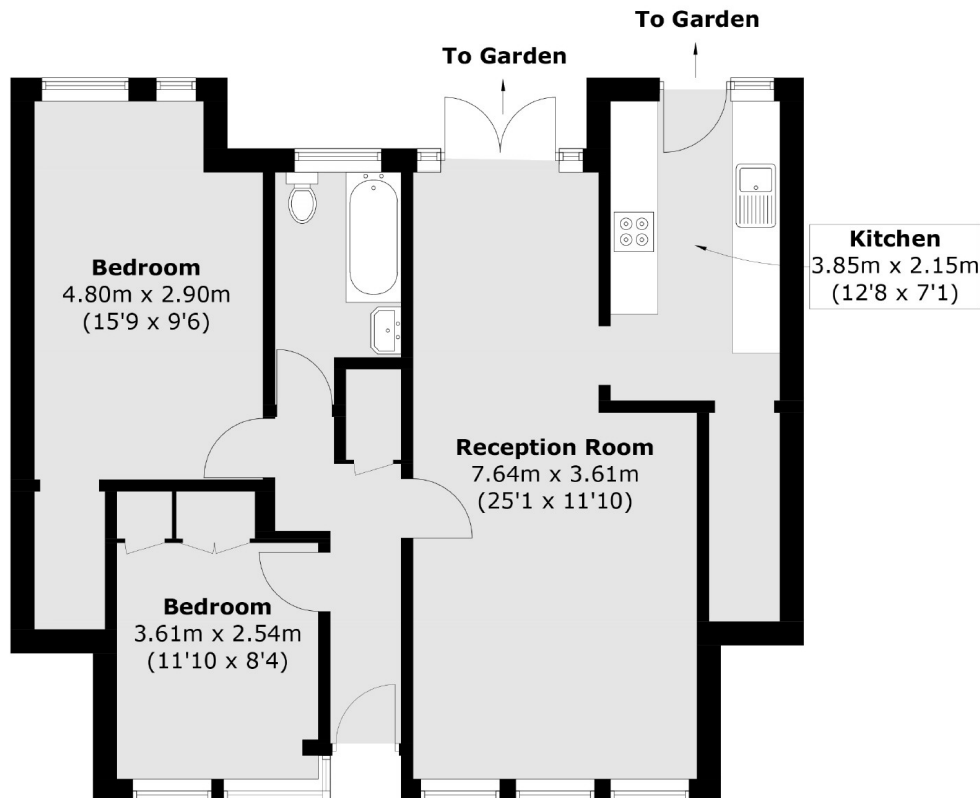

Total area (approx.): 72.3 sq. m (778.2 sq. ft)

Snellers Twickenham Lettings
64-66 Heath Road
Twickenham
TW1 4BX
020 8892 5678
twickenhamlettings@snellers.co.uk

Energy Rating: C We aim to make our particulars both accurate and reliable. However they are not guaranteed; nor do they form part of an offer or contract. If you require clarification on any points then please contact us, especially if you're traveling some distance to view. Please note that appliances and heating systems have not been tested and therefore no warranties can be given as to their good working order