



Park Crescent, TW2

£2,250 PCM

A beautifully presented two double bedroom home in this popular development. The property is in excellent condition throughout and is ideal for a professional couple or family. There is a good sized living room with direct access onto a pretty garden, a well equipped modern kitchen, two double bedrooms and a family bathroom.

Park Crescent is a sought after development accessed off Meadway, in a great catchment area for excellent local schools. Located less than half a mile from Whitton train station.

- Sought After Development • Beautifully Presented • Pretty Garden •
- Two Double Bedrooms • Residents Parking • Close to Station •

SNELLERS

ESTATE AGENTS

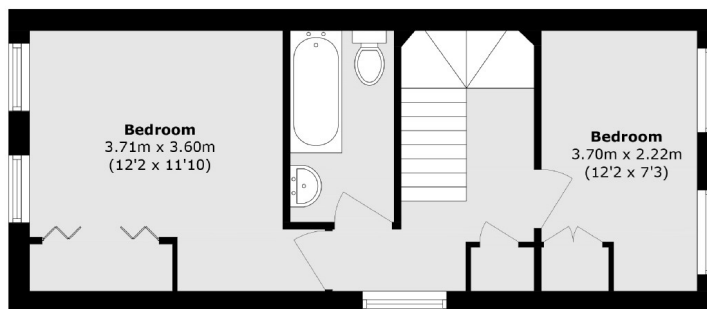

First Floor

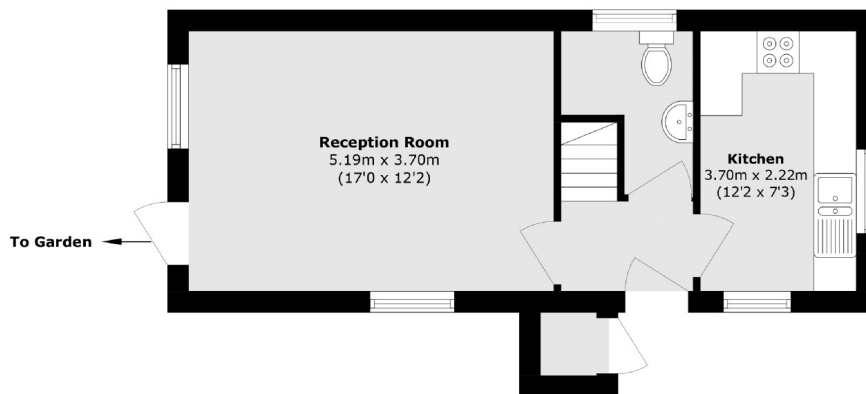

Ground Floor

Total area (approx.): 70.3 sq. m (756.7 sq. ft)

Exterior Storage area (approx.): 0.72 sq. m (7.7 sq. ft)

Snellers Twickenham Lettings
64-66 Heath Road
Twickenham
TW1 4BX
020 8892 5678
twickenhamlettings@snellers.co.uk

Energy Rating: D We aim to make our particulars both accurate and reliable. However they are not guaranteed; nor do they form part of an offer or contract. If you require clarification on any points then please contact us, especially if you're traveling some distance to view. Please note that appliances and heating systems have not been tested and therefore no warranties can be given as to their good working order