

SNELLERS

ESTATE AGENTS



Water Lane, TW1

£899,950

A beautifully presented modern home located moments from the river, with a stylish loft conversion, modern interiors and a fantastic rear garden.



A stylish and modern three double bedroom family home that has been beautifully renovated and loft-converted to create a spacious and elegant living space. Nestled in one of Twickenham's most sought-after locations, this home offers the perfect blend of contemporary comfort and riverside charm and is perfect for families, commuters and those looking to downsize.

Step inside and you'll find bright, modern interiors designed for easy, everyday living. The generous living and dining areas provide the perfect space to relax or entertain, while the well-equipped kitchen is ready for home cooking and family meals. The loft conversion adds valuable extra space, creating a stunning additional bedroom.

Water Lane is moments away Church Street, Twickenham's prettiest cobbled street, lined with independent shops, cafés, and restaurants. The River Thames is on your doorstep, with scenic riverside walks leading to Richmond, and some of the area's best historic pubs are just around the corner. Twickenham Station is within easy reach, offering fast trains to London Waterloo.

- Modern Family Home • Unbeatable Location • River Views •
- Three Bedrooms • Landscaped Garden • Outstanding Schools •



SNELLERS

ESTATE AGENTS

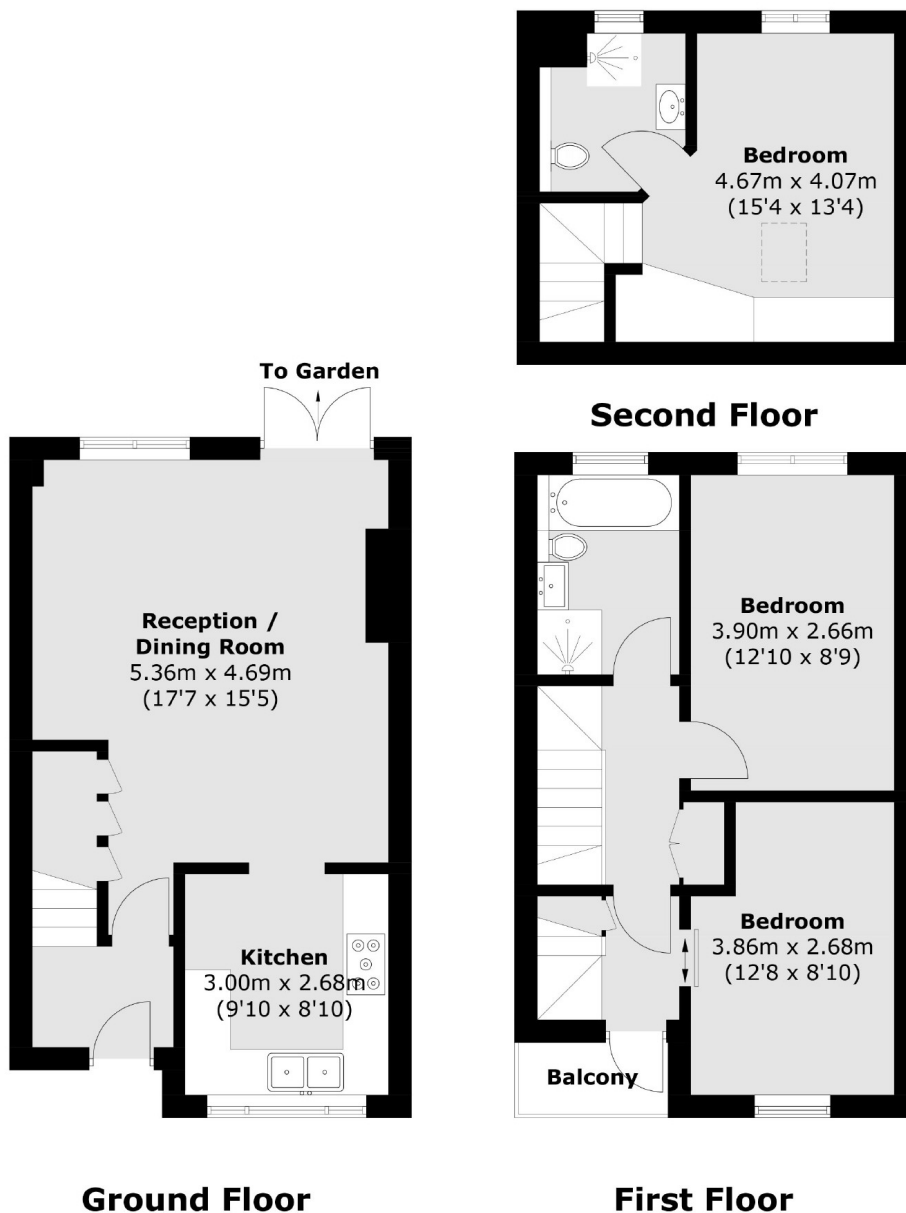

Total area (approx.): 93.8 sq. m (1,009.7 sq. ft)
Balcony area (approx.): 1.8 sq. m (19.4 sq. ft)

Snellers Twickenham Sales
64-66 Heath Road
Twickenham
TW1 4BX
020 8892 5555
twickenhamsales@snellers.co.uk

Energy Rating: C We aim to make our particulars both accurate and reliable. However they are not guaranteed; nor do they form part of an offer or contract. If you require clarification on any points then please contact us, especially if you're traveling some distance to view. Please note that appliances and heating systems have not been tested and therefore no warranties can be given as to their good working order