

# SNELLERS

ESTATE AGENTS

---



## Rivermeads Avenue, TW2

£2,700 PCM

A beautifully presented three bedroom semi-detached family home located along a quiet residential street. The property offers excellent living space including a modern kitchen, off street parking and a private rear garden.

Rivermeads Avenue is a desirable family road located just off Staines Road, set in the catchment area for many of Twickenham's highly rated schools.

- Three Bedrooms • Double Reception Room • Modern Kitchen •
- Private Rear Garden • Off Street Parking • Excellent Location •

# SNELLERS

ESTATE AGENTS

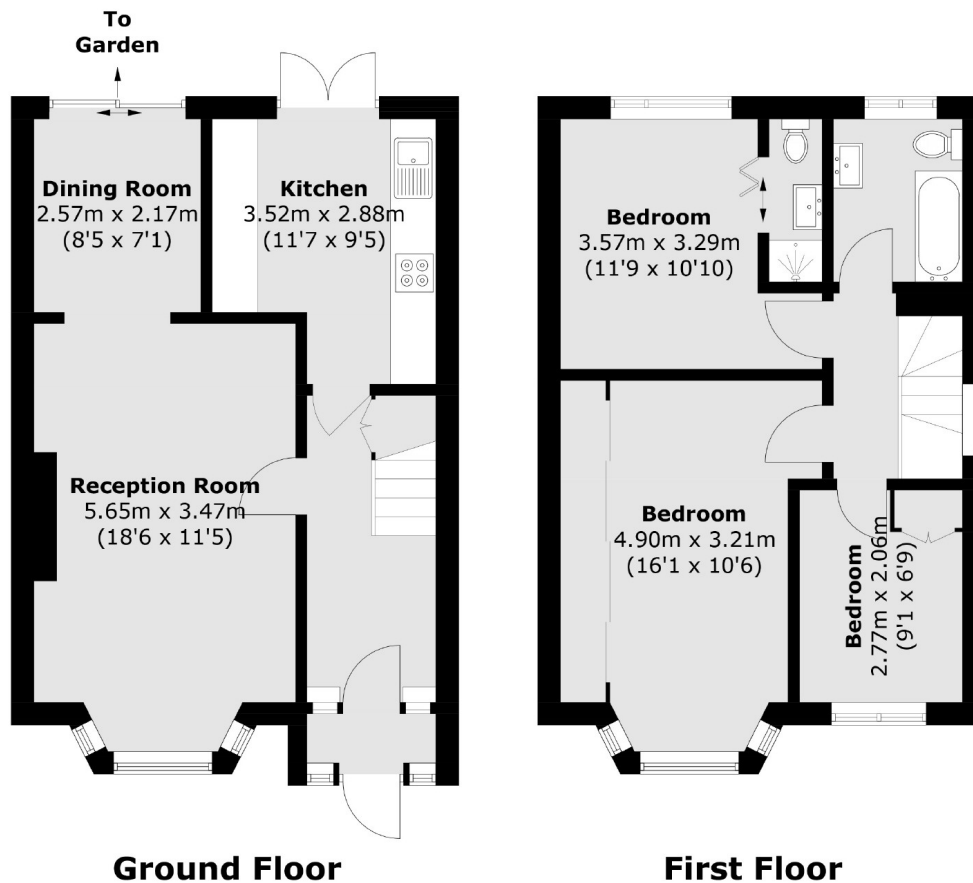

Total area (approx.): 85.9 sq. m (924.6 sq. ft)

Snellers Twickenham Lettings  
64-66 Heath Road  
Twickenham  
TW1 4BX  
020 8892 5678  
[twickenhamlettings@snellers.co.uk](mailto:twickenhamlettings@snellers.co.uk)

Energy Rating: D We aim to make our particulars both accurate and reliable. However they are not guaranteed; nor do they form part of an offer or contract. If you require clarification on any points then please contact us, especially if you're traveling some distance to view. Please note that appliances and heating systems have not been tested and therefore no warranties can be given as to their good working order