



London Road, TW1

£599,950

An immaculately presented modern apartment in the heart of Twickenham. There are two double bedrooms, two bathrooms, an open plan reception / dining room and two generous balconies. The property benefits from intercom system and lift service.

Twickenham Gateway is the new development at Twickenham Station which offers direct links into London Waterloo and is on the London Road, offering plenty of shops, pubs and restaurants. It is also conveniently close to Twickenham Stadium & the River Thames.

- First Floor Apartment • Two Double Bedrooms • Two Bathrooms •
- Two Balconies • Lift Service • Central Twickenham •

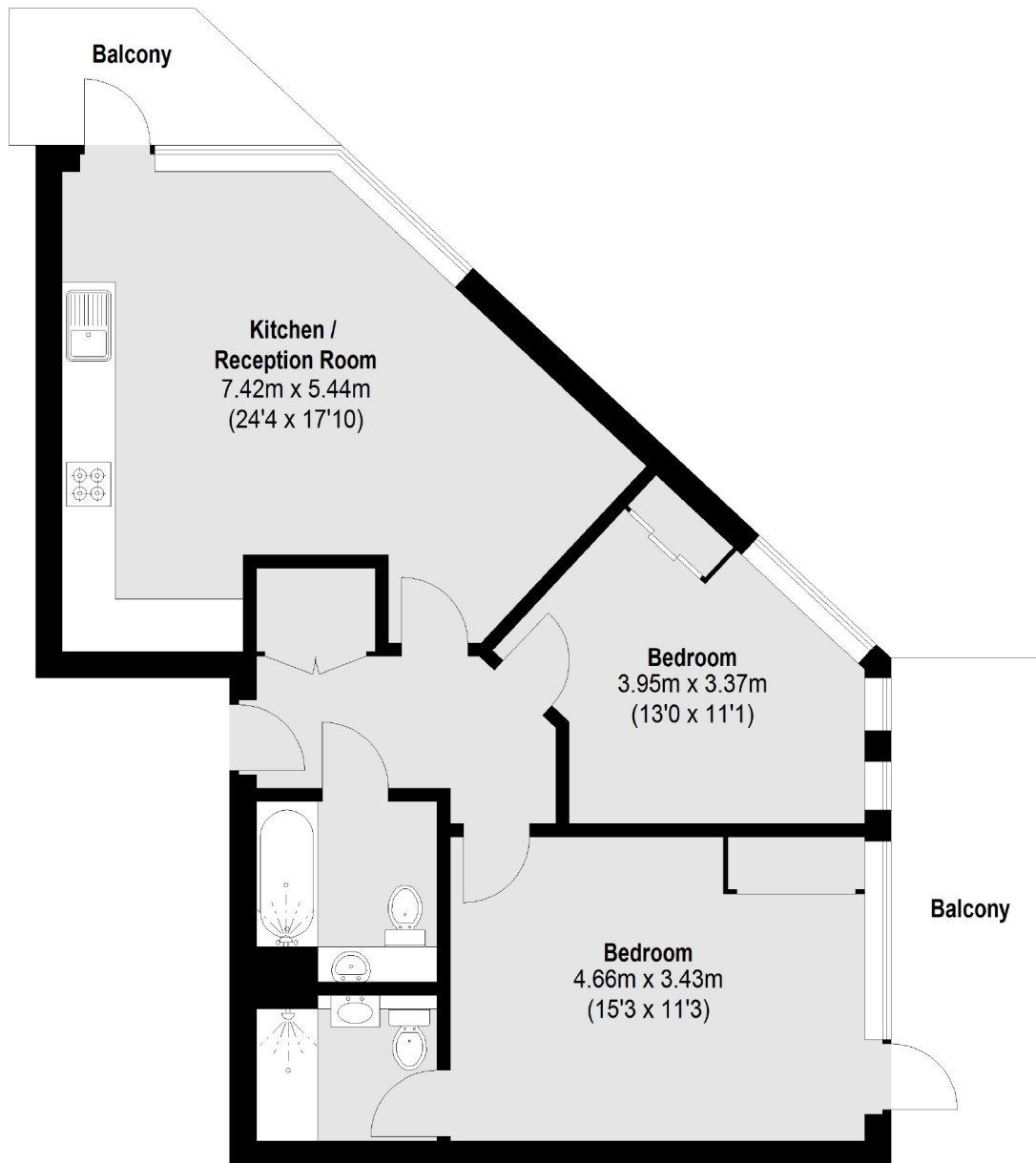

First Floor

Total area (approx.): 71.31 sq. m (768 Sq. ft)
Balconies: 14.67 sq. m (158 Sq. ft)

Snellers Twickenham Sales
64-66 Heath Road
Twickenham
TW1 4BX
020 8892 5555
twickenhamsales@snellers.co.uk

Energy Rating: B We aim to make our particulars both accurate and reliable. However they are not guaranteed; nor do they form part of an offer or contract. If you require clarification on any points then please contact us, especially if you're traveling some distance to view. Please note that appliances and heating systems have not been tested and therefore no warranties can be given as to their good working order