



Bramley Close, TW2

£335,000

This two bedroom ground floor maisonette has direct access to a private garden and is offered to the market with no onward chain. The property has two bedrooms, a spacious reception room, modern bathroom and a separate kitchen. The property is well located for transport and fantastic primary and secondary schools, so is perfect for both commuters and families.

Bramley Close is a popular street close to Murray Park, Whitton high street and Whitton Station which has direct links into London Waterloo.

- Two Bedrooms • Private Garden • Separate Storage Area •
- Ground Floor • Private Entrance • Close To Station •

SNELLERS

ESTATE AGENTS

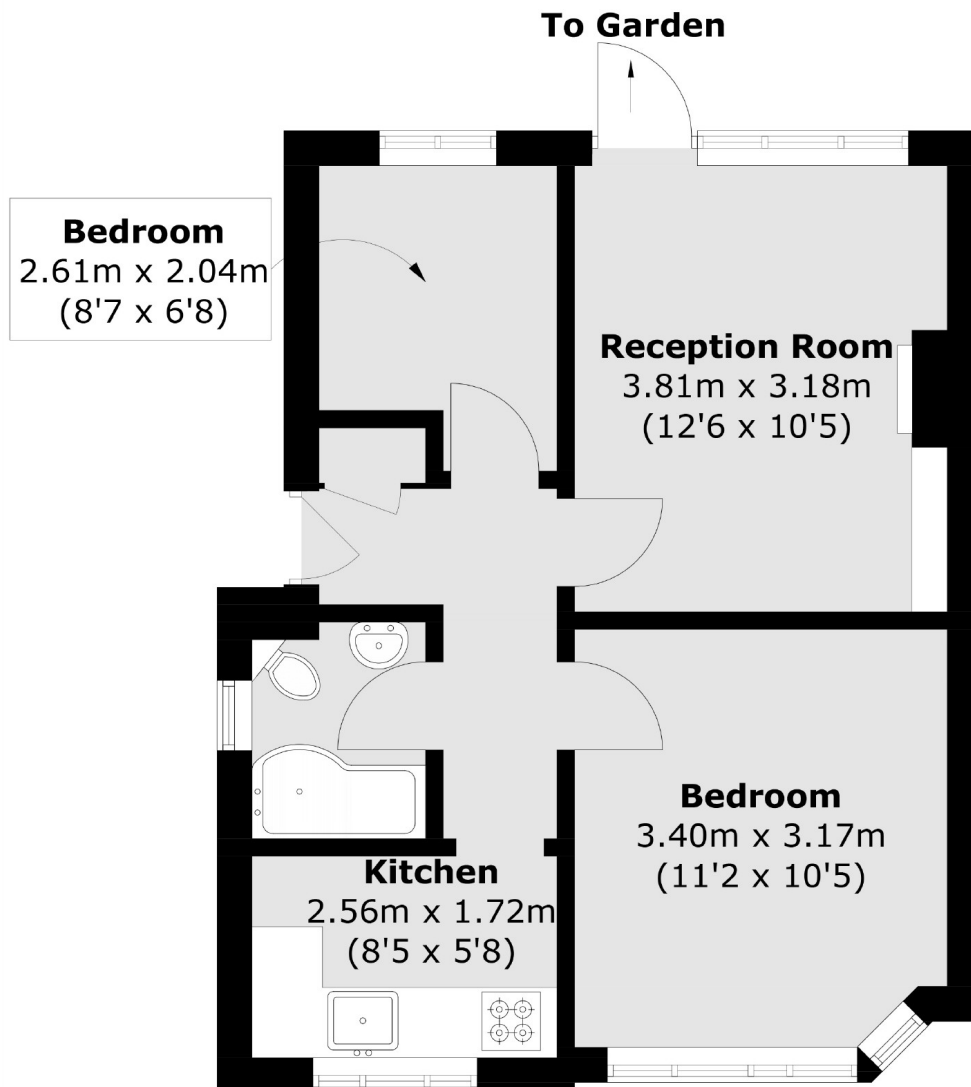

Total area (approx.): 42.6 sq. m (458.5 sq. ft)

Snellers Twickenham Sales
64-66 Heath Road
Twickenham
TW1 4BX
020 8892 5555
twickenhamsales@snellers.co.uk

Energy Rating: D We aim to make our particulars both accurate and reliable. However they are not guaranteed; nor do they form part of an offer or contract. If you require clarification on any points then please contact us, especially if you're traveling some distance to view. Please note that appliances and heating systems have not been tested and therefore no warranties can be given as to their good working order