



Talma Gardens, TW2

£450,000

This beautifully presented three double bedroom maisonette is a must view property! There are very few maisonettes or apartments offering three double bedrooms so this property really stands out from other choices on the market. The third bedroom can be used as a bedroom, home office or gym so the space is flexible and will suit a wide range of buyers. From commuters, to couples to families this property is a fantastic buy.

Talma Gardens is a popular residential road just 0.8 miles from Twickenham Station with fast links to London Waterloo and the high street which has plenty of shops, pubs and restaurants.

- Three Double Bedrooms • Beautifully Presented • Private Entrance •
- Communal Garden • Long Lease • Close to Station •

SNELLERS

ESTATE AGENTS

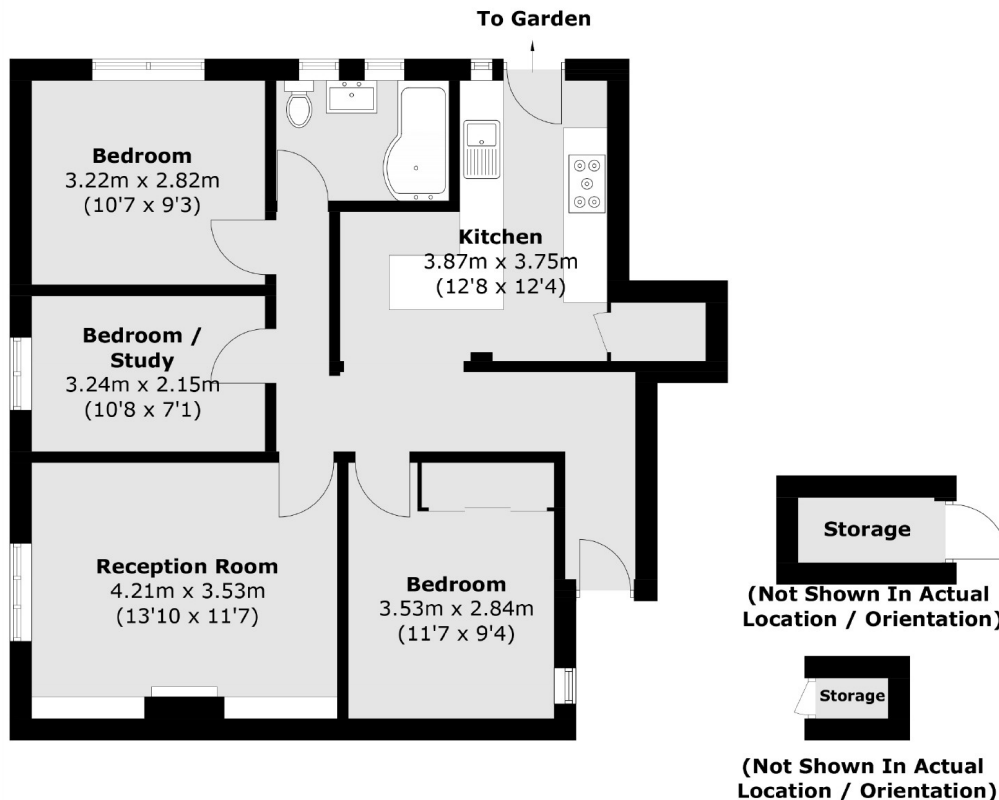

Total area (approx.): 70.9 sq. m (763.1 sq. ft)
External Storage area (approx.): 2.4 sq. m (25.8 sq. ft)

Snellers Twickenham Sales
64-66 Heath Road
Twickenham
TW1 4BX
020 8892 5555
twickenhamsales@snellers.co.uk

Energy Rating: TBC We aim to make our particulars both accurate and reliable. However they are not guaranteed; nor do they form part of an offer or contract. If you require clarification on any points then please contact us, especially if you're traveling some distance to view. Please note that appliances and heating systems have not been tested and therefore no warranties can be given as to their good working order