

SNELLERS

ESTATE AGENTS



Lisbon Avenue, TW2

£599,950

This 1930's three bedroom family home is situated in this highly popular road and comes with the added benefits of three bedrooms, potential to further extend, front and south facing rear garden and a garage at the end of the garden with rear access.

Lisbon Avenue is within walking distance of Twickenham Green, Crane Park and the high street. There are fantastic transports links and schools, both private and state-run, including Waldegrave Girls School rated outstanding by Ofsted.

- Potential To Extend
- South Facing Garden
- Garage
- Three Bedrooms
- Popular Location
- Close to Amenities

SNELLERS

ESTATE AGENTS

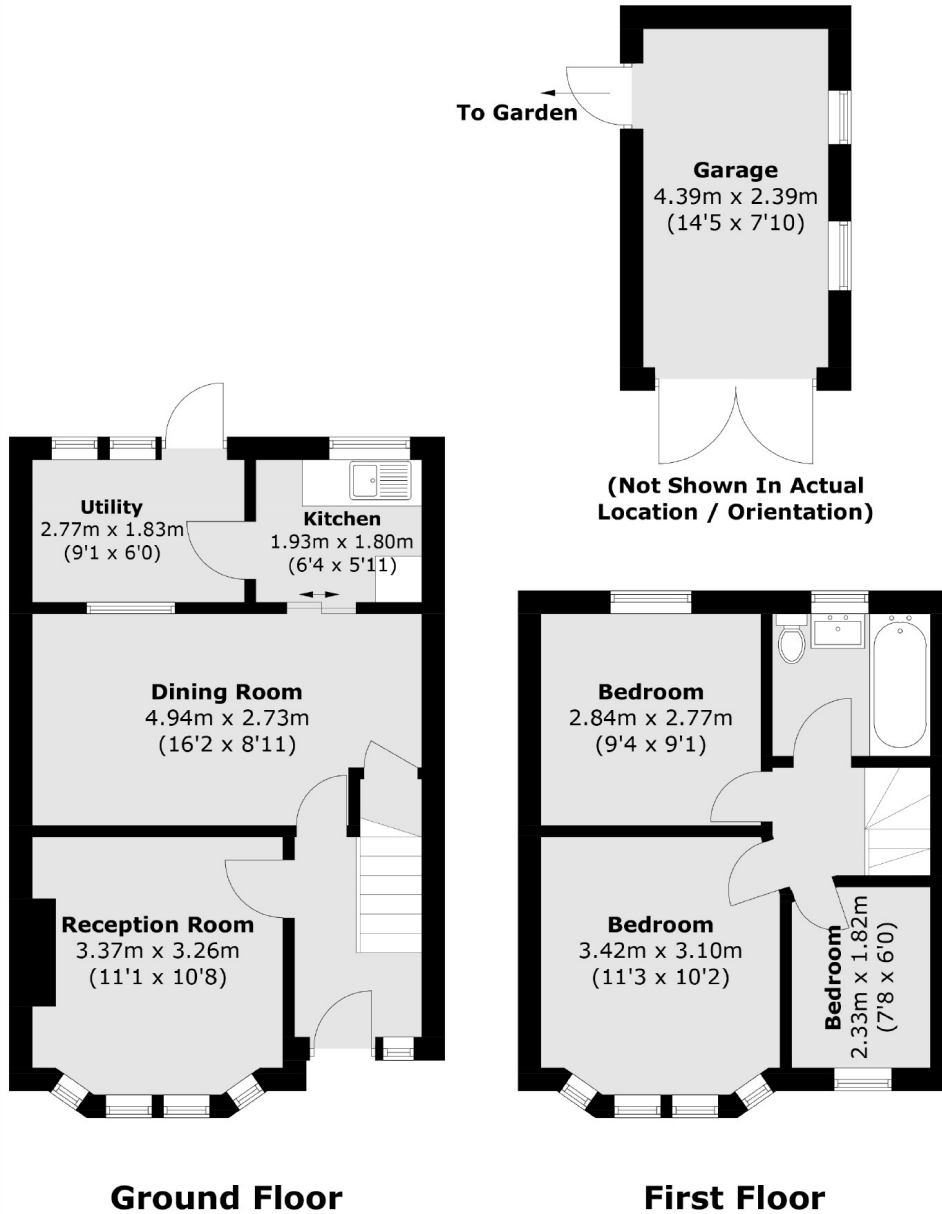

Total area (approx.): 70.7 sq. m (761.0 sq. ft)
Garage area (approx.): 11.0 sq. m (118.4 sq. ft)

Snellers Twickenham Sales
64-66 Heath Road
Twickenham
TW1 4BX
020 8892 5555
twickenhamsales@snellers.co.uk

Energy Rating: D We aim to make our particulars both accurate and reliable. However they are not guaranteed; nor do they form part of an offer or contract. If you require clarification on any points then please contact us, especially if you're traveling some distance to view. Please note that appliances and heating systems have not been tested and therefore no warranties can be given as to their good working order