

SNELLERS

ESTATE AGENTS



Brinsworth Close, TW2

£599,950

A stylish two double bedroom house in a sought after residential street, complete with residents parking and a landscaped garden. Further benefits include built in storage, contemporary design and potential to further extend subject to planning permission.

Brinsworth Close is located off Staines Road, just 0.4 miles to Twickenham Green. Excellently located for a range of outstanding local schools, shops and cafés. Strawberry Hill and Fulwell Stations are less than 1 mile away.

- Two Double Bedrooms • Stylish Design • Built In Storage •
- Share Of Freehold • Potential To Extend (STPP) • Parking •

SNELLERS

ESTATE AGENTS

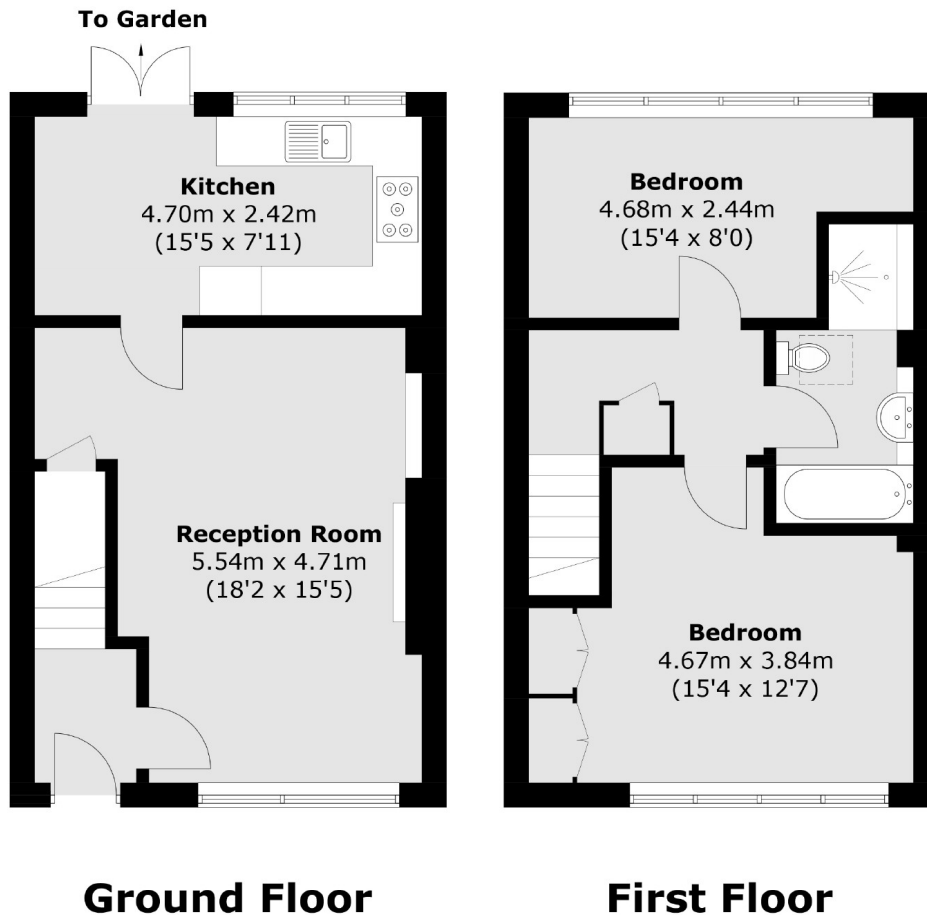

Total area (approx.): 76.4 sq. m (822.3 sq. ft)

Snellers Twickenham Sales
64-66 Heath Road
Twickenham
TW1 4BX
020 8892 5555
twickenhamsales@snellers.co.uk

Energy Rating: C We aim to make our particulars both accurate and reliable. However they are not guaranteed; nor do they form part of an offer or contract. If you require clarification on any points then please contact us, especially if you're traveling some distance to view. Please note that appliances and heating systems have not been tested and therefore no warranties can be given as to their good working order