

# SNELLERS

ESTATE AGENTS



## Manor Road, TW2

£1,795 PCM

This two bedroom apartment is set in a popular development on a quiet street in Twickenham. The property has a separate kitchen, large living room and two double bedrooms. Additional benefits include a balcony, communal gardens and private residents parking.

Manor Road is a popular cul-de-sac located off Staines Road, within one mile of Twickenham town centre and train station and just 0.6 Miles from Twickenham Green.

- Two Double Bedrooms • Large Reception Room • Balcony •
- Communal Gardens • Separate Kitchen • Residents Parking •

# SNELLERS

ESTATE AGENTS

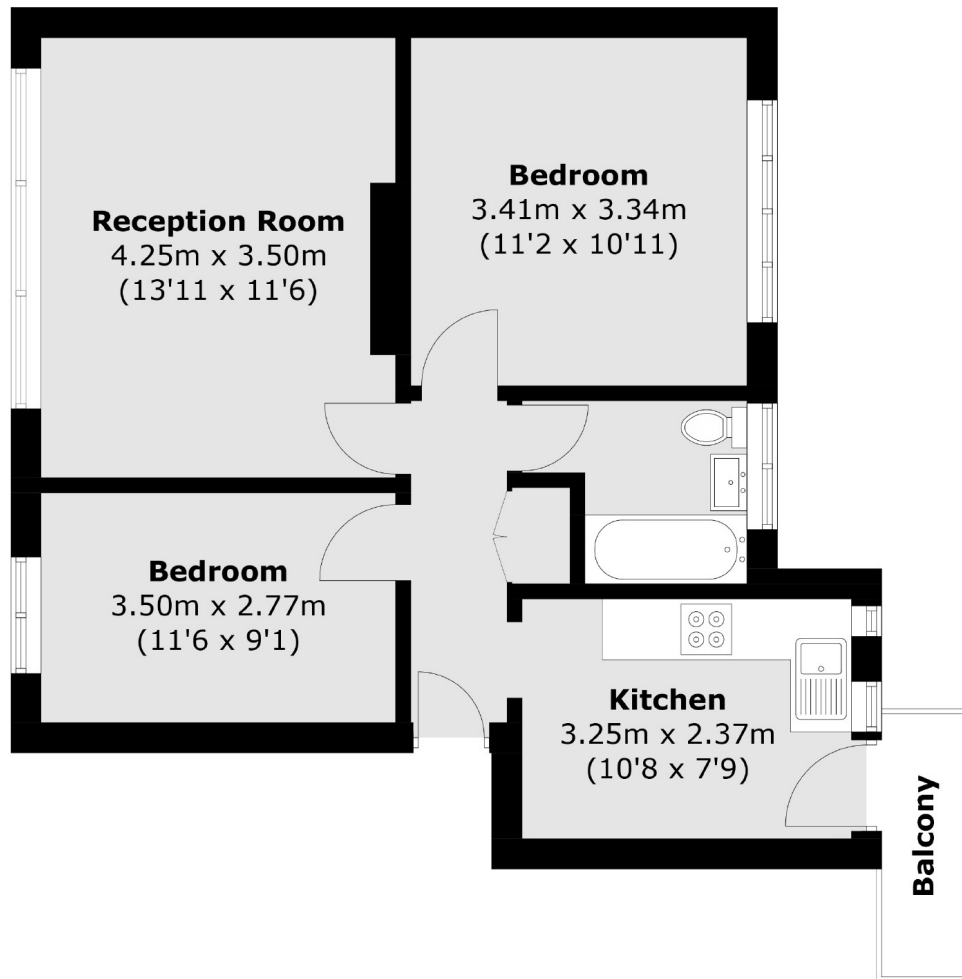

Total area (approx.): 52.4 sq. m (564.0 sq. ft)  
Balcony: 2.2 sq. m (23.7 sq. ft)

Snellers Twickenham Lettings  
64-66 Heath Road  
Twickenham  
TW1 4BX  
020 8892 5678  
[twickenhamlettings@snellers.co.uk](mailto:twickenhamlettings@snellers.co.uk)

Energy Rating: D We aim to make our particulars both accurate and reliable. However they are not guaranteed; nor do they form part of an offer or contract. If you require clarification on any points then please contact us, especially if you're traveling some distance to view. Please note that appliances and heating systems have not been tested and therefore no warranties can be given as to their good working order