

# SNELLERS

ESTATE AGENTS



## Cheltenham Avenue, TW1

£425,000

This wonderful first floor maisonette has two double bedrooms, a spacious reception room, a modern kitchen and bathroom. The property is situated in a prime location and has the added benefit of a private garden, loft space, long lease (900 plus years) and no service charge.

Cheltenham Avenue is ideally located in the heart of Twickenham town centre and is close to all local amenities, including the mainline station, shops, bars and restaurants.

- Long Lease & Low Charges • Central Location • Private Garden •
- Two Double Bedrooms • Modern Kitchen/Bathroom • Potential To Extend (STPP) •

# SNELLERS

ESTATE AGENTS

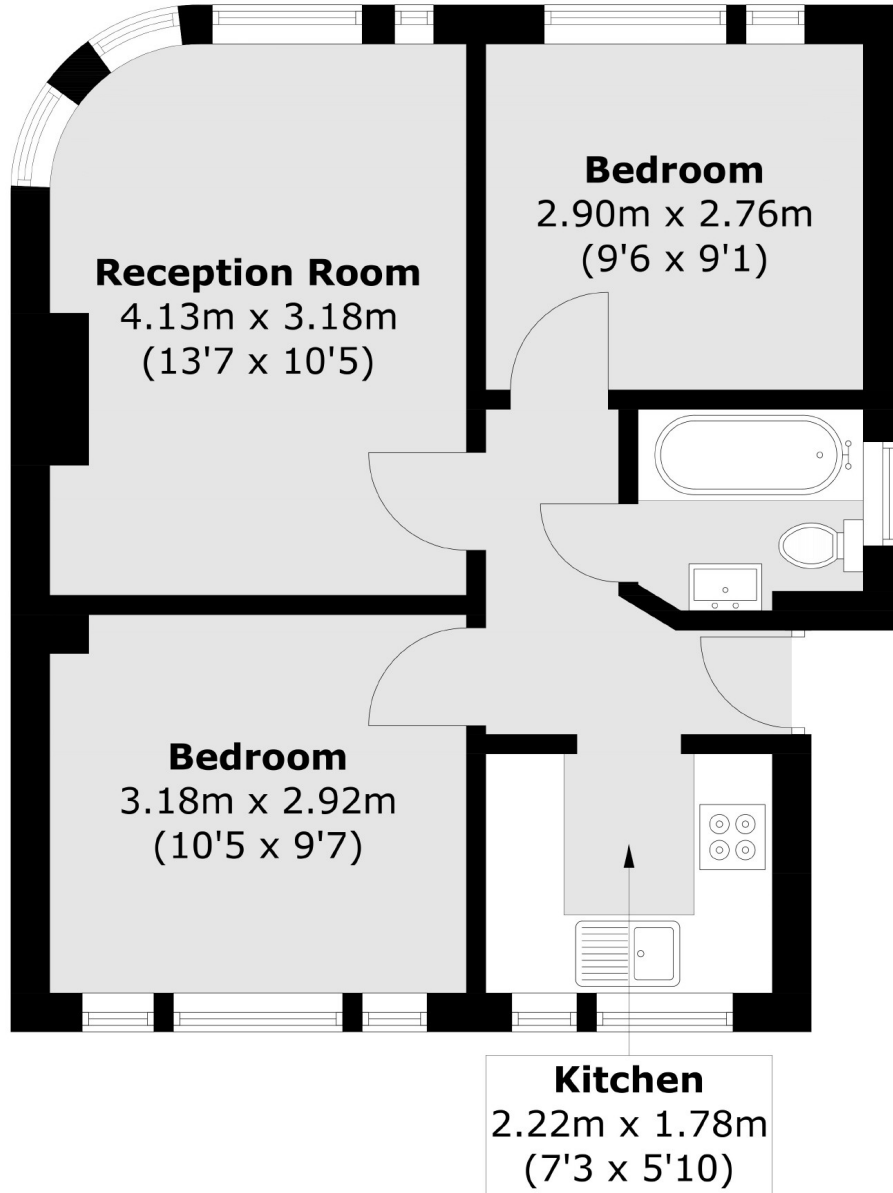

Total area (approx.): 43.4 sq. m (467.1 sq. ft)

Snellers Twickenham Sales  
64-66 Heath Road  
Twickenham  
TW1 4BX  
020 8892 5555  
twickenhamsales@snellers.co.uk

Energy Rating: We aim to make our particulars both accurate and reliable. However they are not guaranteed; nor do they form part of an offer or contract. If you require clarification on any points then please contact us, especially if you're traveling some distance to view. Please note that appliances and heating systems have not been tested and therefore no warranties can be given as to their good working order