

SNELLERS

ESTATE AGENTS



Lyndhurst Avenue, TW2

£695,000

This two bedroom semi detached bungalow is presented in excellent condition throughout, it has been tastefully modernised and benefits from having bespoke features, a large garden, off street parking for multiple cars and potential to extend further (STPP).



Beautifully designed and renovated by the current owners, the garden consists of a bar, as well as a large fully insulated brick built outbuilding / workshop. Fully insulated roof, with double glazed windows, power and LED lighting, hot and cold water, electric heating and mains drainage. The kitchen/dining area is a great space for a family and entertaining.

Lyndhurst Avenue is a quiet residential road located on the popular Woodlawn Estate, within close proximity to Whitton high street and mainline station and is within walking distance of popular local schools and parks.

- Semi Detached • Bungalow • Large Garden •
- Off Street Parking • Popular Location • Excellent Finish •



SNELLERS

ESTATE AGENTS

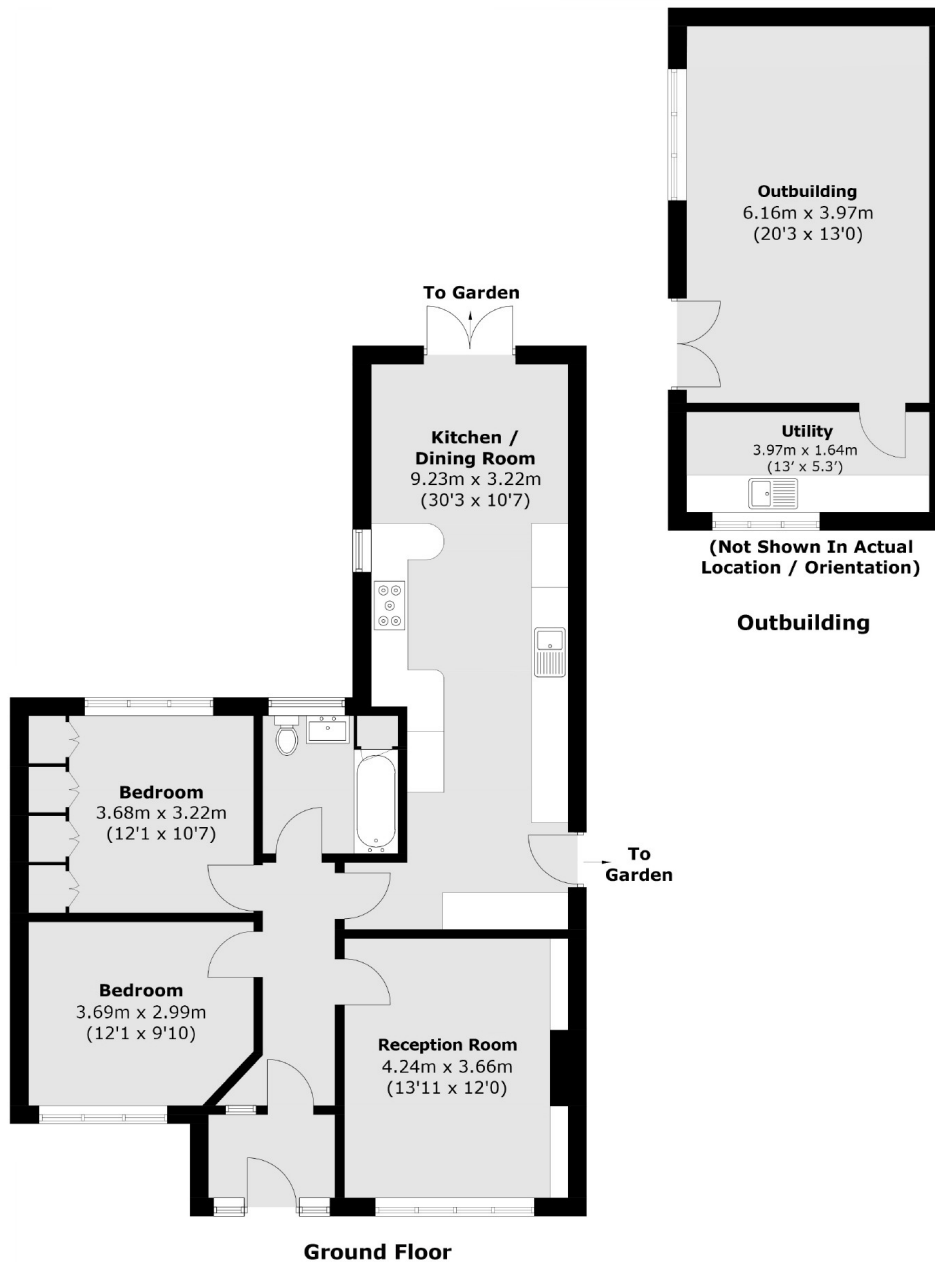

Total area (approx.): 84.1 sq. m (905.2 sq. ft)
Outbuilding area (approx.): 31.8 sq. m (342.3 sq. ft)

Snellers Twickenham Sales
64-66 Heath Road
Twickenham
TW1 4BX
020 8892 5555
twickenhamsales@snellers.co.uk

Energy Rating: D We aim to make our particulars both accurate and reliable. However they are not guaranteed; nor do they form part of an offer or contract. If you require clarification on any points then please contact us, especially if you're traveling some distance to view. Please note that appliances and heating systems have not been tested and therefore no warranties can be given as to their good working order