

SNELLERS

ESTATE AGENTS



Cross Deep, TW1

£1,175,000

A stunning family home with enviable views overlooking Radnor Gardens and the River Thames.



This spacious semi detached three bedroom 1930's family home is immaculately presented throughout and benefits from great entertaining space on the ground floor, a utility room, ample storage, potential to extend (STPP), rear access and a studio at the end of a fabulous West facing rear garden.

Cross Deep boasts incredible views of the River Thames and is a short walk to Twickenham town centre, which offer a vast array of shops, bars, restaurants and independent boutiques. Strawberry Hill and Twickenham mainline stations are less than half a mile away and provide routes to and from the city. The property is in the catchment for outstanding local schools, both private and state-run.

- Three Bedrooms • Potential To Extend • West Facing Garden •
- Riverside Location • Great School Catchment • Good Transport Links •



SNELLERS

ESTATE AGENTS

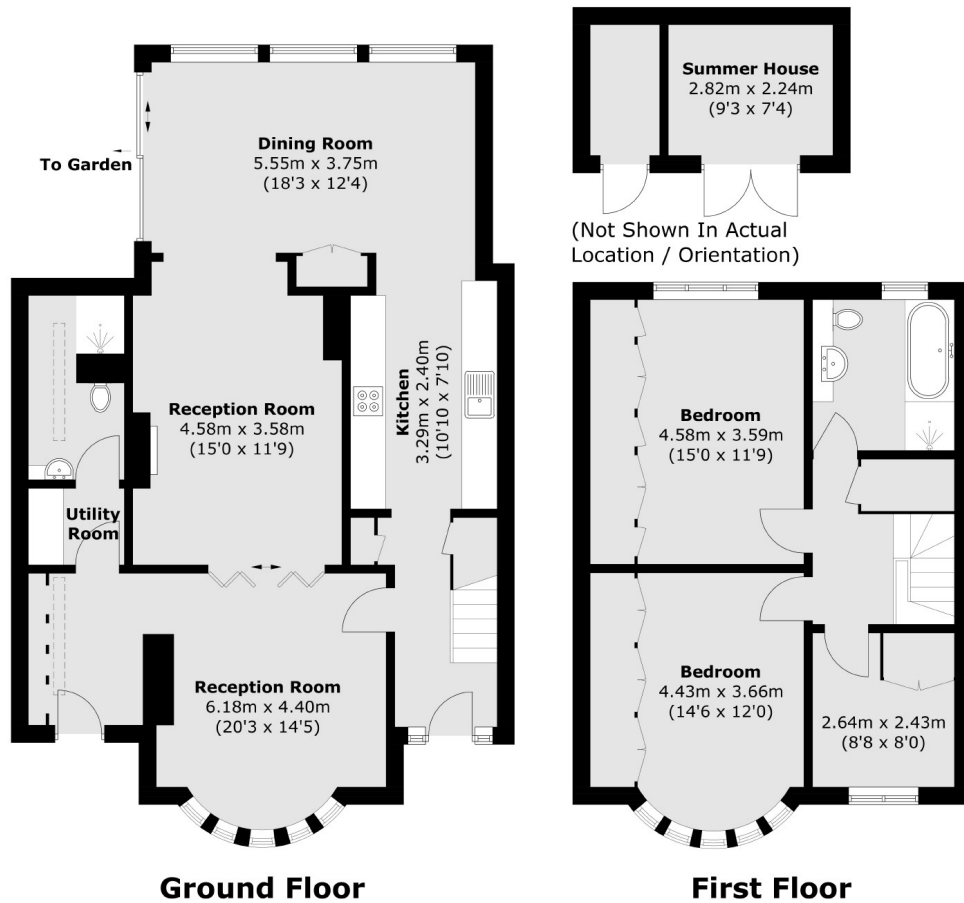

Total area (approx.): 141.3 sq. m (1,520.9 sq. ft)
Outbuilding: 9.7 sq. m (104.4 sq. ft)

Snellers Twickenham Sales
64-66 Heath Road
Twickenham
TW1 4BX
020 8892 5555
twickenhamsales@snellers.co.uk

Energy Rating: D We aim to make our particulars both accurate and reliable. However they are not guaranteed; nor do they form part of an offer or contract. If you require clarification on any points then please contact us, especially if you're traveling some distance to view. Please note that appliances and heating systems have not been tested and therefore no warranties can be given as to their good working order