

# SNELLERS

ESTATE AGENTS



## Manor Road, TW2

£365,000

A beautifully presented first floor flat with two double bedrooms, a good size reception room and a modern kitchen and bathroom. Further benefits include no chain, residents parking, shared balcony and direct access to well kept communal gardens.

Manor Court is a popular residential development which is close to excellent schools such as Waldegrave Girls and Trafalgar School. Twickenham Green and the high street are less than a mile away.

- Modern • Two Double Bedrooms • Popular Location •
- Communal Gardens • First Floor • No Chain •

# SNELLERS

ESTATE AGENTS

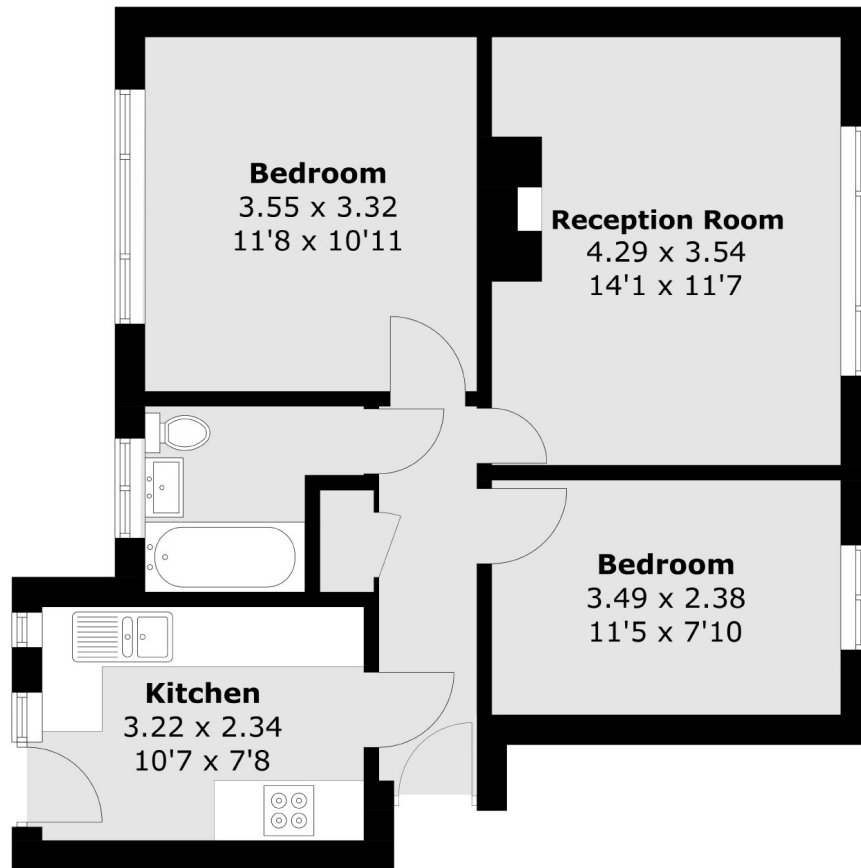

Total area (approx.): 53.4 sq. m (574.8 sq. ft)

Snellers Twickenham Sales  
64-66 Heath Road  
Twickenham  
TW1 4BX  
020 8892 5555  
twickenhamsales@snellers.co.uk

Energy Rating: C We aim to make our particulars both accurate and reliable. However they are not guaranteed; nor do they form part of an offer or contract. If you require clarification on any points then please contact us, especially if you're traveling some distance to view. Please note that appliances and heating systems have not been tested and therefore no warranties can be given as to their good working order