



Villiers Avenue, TW2

£640,000

This modernised three bedroom semi detached bungalow is presented in excellent condition throughout. Benefiting from off street parking to the front, side access, potential to extend (STPP), a detached garage and a sunny West facing rear garden.

Villiers Avenue is located in the popular Woodlawn Estate leading to the River Crane and Crane Park. Both Whitton high street and Whitton station are just over a mile away which offers you a fast link to London Waterloo and a number of good schools nearby.

- Popular Location • Three Bedrooms • Sunny Garden •
- Off Street Parking • Modern Finish • Great School Catchment •

SNELLERS

ESTATE AGENTS

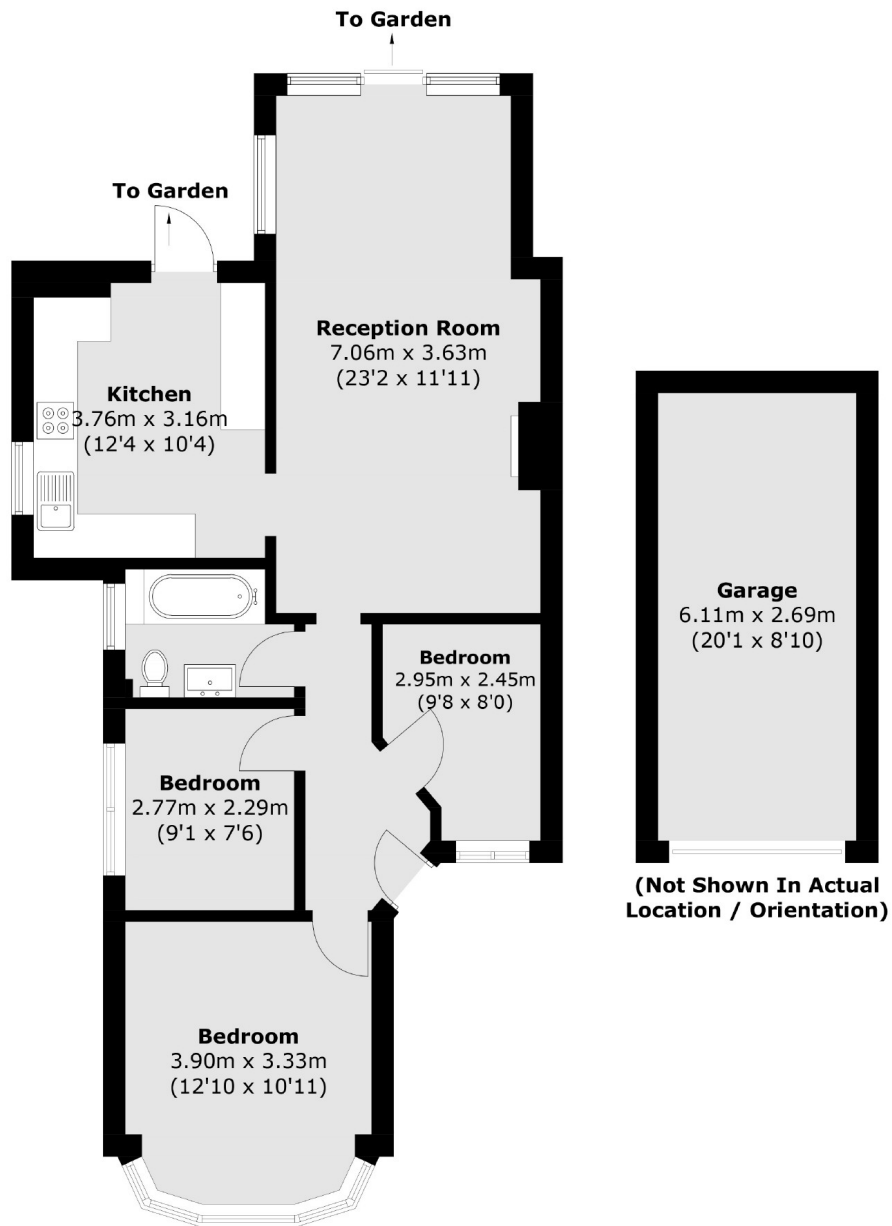

Total area (approx.): 72.4 sq. m (779.3 sq. ft)
Garage area (approx.): 16.5 sq. m (177.6 sq. ft)

Snellers Twickenham Sales
64-66 Heath Road
Twickenham
TW1 4BX
020 8892 5555
twickenhamsales@snellers.co.uk

Energy Rating: D We aim to make our particulars both accurate and reliable. However they are not guaranteed; nor do they form part of an offer or contract. If you require clarification on any points then please contact us, especially if you're traveling some distance to view. Please note that appliances and heating systems have not been tested and therefore no warranties can be given as to their good working order