

SNELLERS

ESTATE AGENTS



Lincoln Avenue, TW2

£630,000

This three bedroom semi detached house is offered to the market with no chain and has the benefit of a south facing garden which backs onto Crane Park, off street parking and potential to extend (STPP).

Lincoln Avenue is a desirable road in the 'Counties' development, moments away from Kneller Gardens and less than a mile to both Twickenham Green & Whitton stations.

- Three Bedrooms • Potential To Extend (STPP) • Semi Detached •
- OSP • South Facing Garden • Great School Catchment •

SNELLERS

ESTATE AGENTS

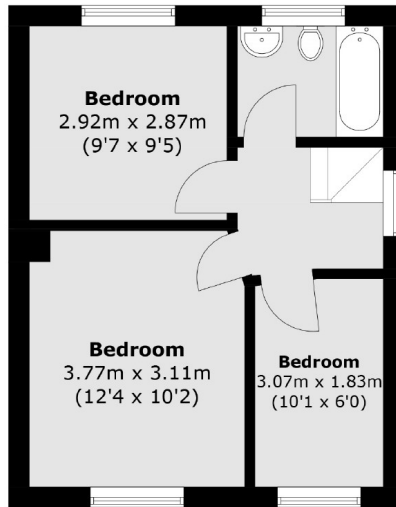

First Floor

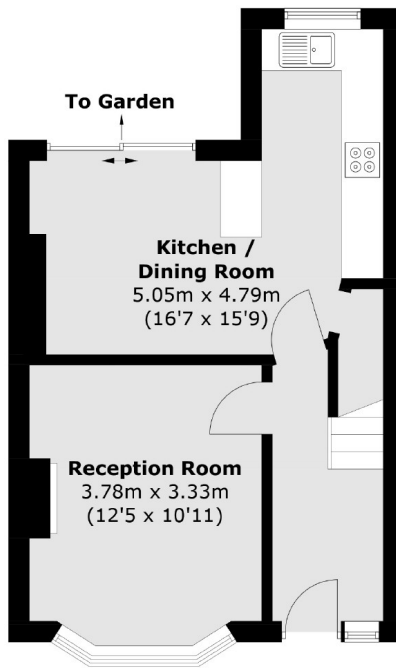

Ground Floor

Total area (approx.): 72.3 sq. m (778.2 sq. ft)

Snellers Twickenham Sales
64-66 Heath Road
Twickenham
TW1 4BX
020 8892 5555
twickenhamsales@snellers.co.uk

Energy Rating: D We aim to make our particulars both accurate and reliable. However they are not guaranteed; nor do they form part of an offer or contract. If you require clarification on any points then please contact us, especially if you're traveling some distance to view. Please note that appliances and heating systems have not been tested and therefore no warranties can be given as to their good working order