



Cambridge Road, TW11

£499,950

A fabulous ground and first floor maisonette benefitting from direct access to a large communal garden. This apartment offers almost 900 sq ft of newly decorated living space and also has the advantage of no chain.

This apartment is situated in a superb central Teddington location, just off the High Street. Teddington station is about half a mile away and there is also easy access to Bushy Park and the river Thames too.

- Large Reception Room • Separate Kitchen • Three Bedrooms •
- Bathroom • Communal Gardens •

SNELLERS

ESTATE AGENTS

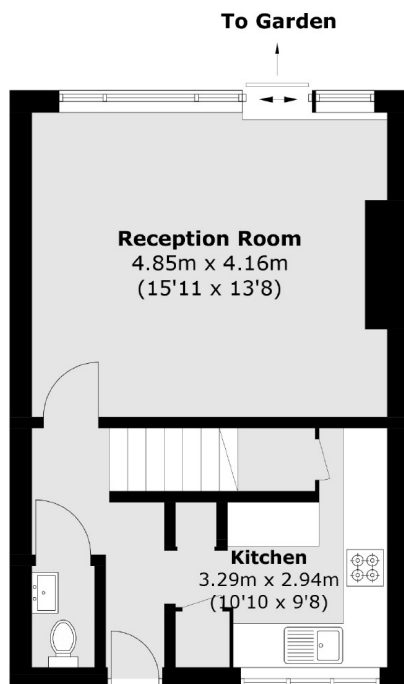

Ground Floor

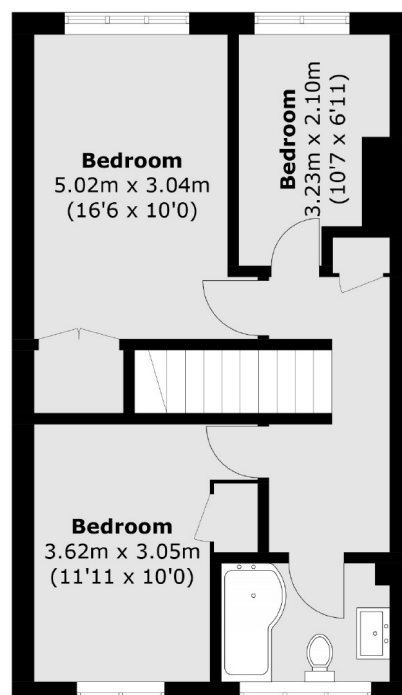

First Floor

Total area (approx.): 79.8 sq. m (859.9 sq. ft)

Snellers Teddington Sales
74 Broad Street
Teddington
TW11 8QX
020 8408 8040
teddingtonsales@snellers.co.uk

Energy Rating: C We aim to make our particulars both accurate and reliable. However they are not guaranteed; nor do they form part of an offer or contract. If you require clarification on any points then please contact us, especially if you're traveling some distance to view. Please note that appliances and heating systems have not been tested and therefore no warranties can be given as to their good working order