

SNELLERS

ESTATE AGENTS



Church Lane, TW11

£775,000

A beautifully presented end-terraced period cottage which has been the subject of total renovation by the current owners in recent years. This lovely home offers almost 700 sq.ft of living space set over two floors, and has a delightful rear garden.



On the ground floor there is a small entrance hall, and at the front of the house there is a formal reception room. This room has sash windows with fitted shutters. At the rear of the house there is a lovely reception room, with built-in storage cupboards giving plenty of space to relax with your family. The kitchen has a range of contemporary style units at eye and base level and there is a vaulted ceiling with skylight window. There are bi-folding doors leading onto the rear garden.

On the first floor there are two bedrooms, and there is a recently re-fitted shower room.

Externally, there is a delightful landscaped rear garden which has a patio to the house itself with the remainder being artificial lawn. There is a garden shed and there is rear access too.

This house is ideally situated in a quiet cul-de-sac location just a few moments from the High Street. Teddington station is just a few moments walk and there is easy access to Royal Bushy Park.

- Two Bedrooms • Two Reception Rooms • Extended Kitchen •
- Shower Room • Fabulous Garden • Central Location •



SNELLERS

ESTATE AGENTS

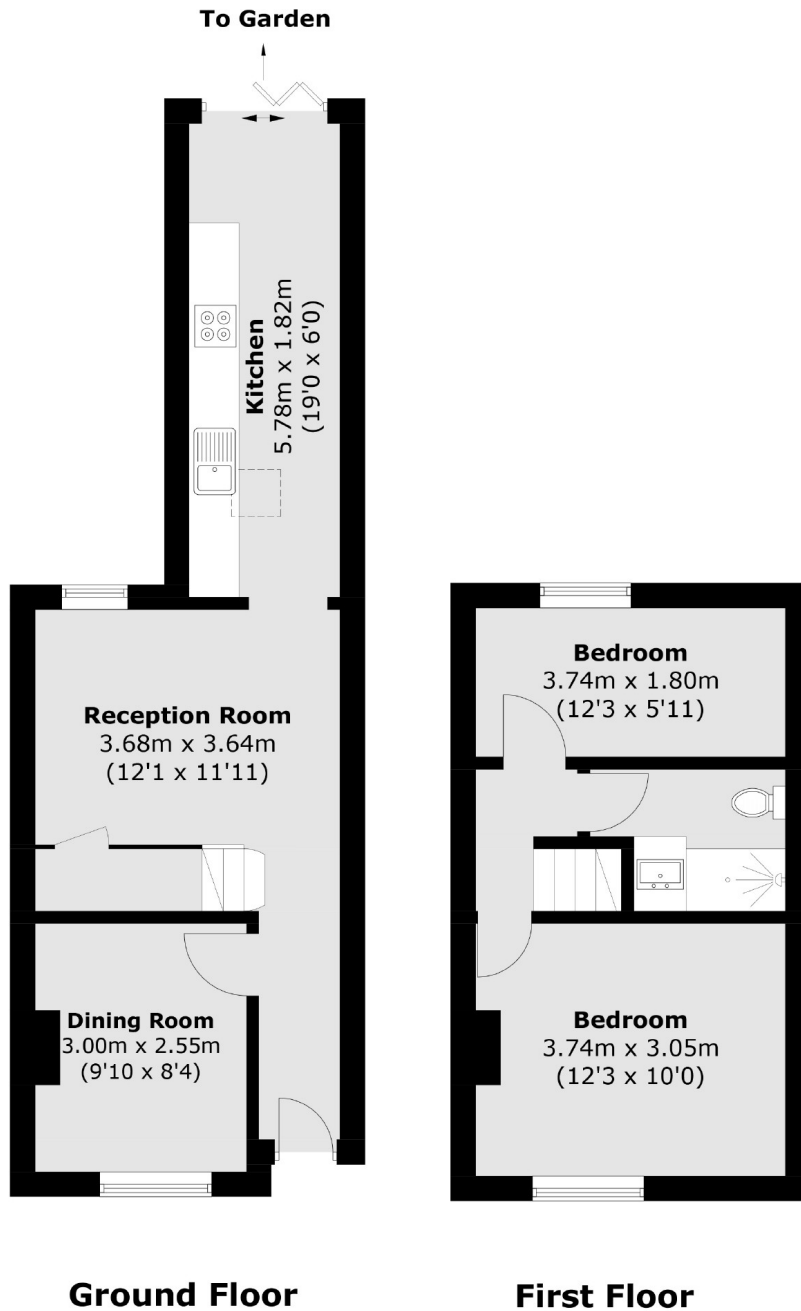

Total area (approx.): 61.1 sq. m (657.6 sq. ft)

Snellers Teddington Sales
74 Broad Street
Teddington
TW11 8QX
020 8408 8040
teddingtonsales@snellers.co.uk

Energy Rating: E We aim to make our particulars both accurate and reliable. However they are not guaranteed; nor do they form part of an offer or contract. If you require clarification on any points then please contact us, especially if you're traveling some distance to view. Please note that appliances and heating systems have not been tested and therefore no warranties can be given as to their good working order