

SNELLERS

ESTATE AGENTS



Watts Lane, TW11

£3,000 PCM

A beautifully presented Victorian home which has been extended and cleverly reconfigured to offer stylish contemporary living space. The house has three bedrooms, a dressing room and a modern bathroom with shower.



The house has three bedrooms, a dressing room, a modern bathroom with shower and an additional attic room that can be used as a study.

There is a spacious living room with wooden flooring, extended kitchen, and double height dining room with floor to ceiling windows overlooked by a mezzanine hallway above.

To the rear of the property is a private courtyard garden with side access and a large driveway providing off-street parking for two cars.

Watts Lane is directly off Teddington High Street with its array of bars, shops and restaurants, and is a short walk to the Station and Teddington Lock.

- Three Bedroom • Victorian House • Dressing Room •
- Private Garden • Off Street Parking • Modern Bathroom •



SNELLERS

ESTATE AGENTS

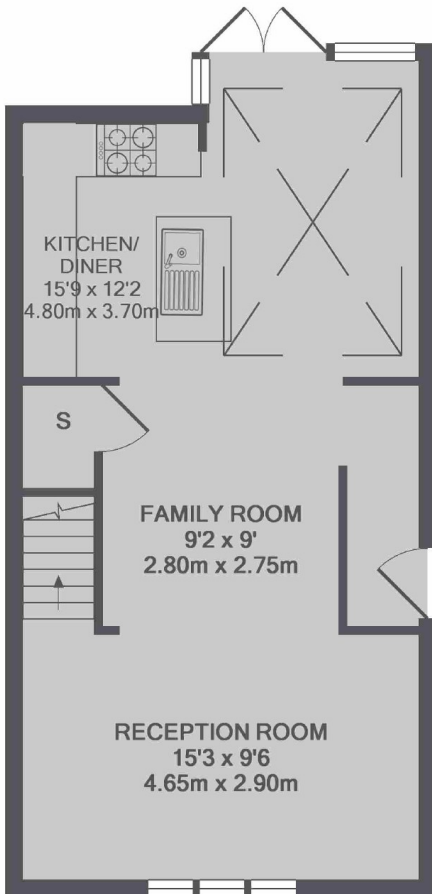

GROUND FLOOR



1ST FLOOR

TOTAL APPROX. FLOOR AREA 1006 SQ.FT. (93.5 SQ.M.)

Snellers Teddington Lettings
74 Broad Street
Teddington
TW11 8QX
020 8614 6140
teddingtonlettings@snellers.co.uk

Energy Rating: D We aim to make our particulars both accurate and reliable. However they are not guaranteed; nor do they form part of an offer or contract. If you require clarification on any points then please contact us, especially if you're traveling some distance to view. Please note that appliances and heating systems have not been tested and therefore no warranties can be given as to their good working order