

SNELLERS

ESTATE AGENTS



Manor Road, TW11

£495,000

A fabulous first floor apartment forming part of a popular riverside development. The apartment offers almost 800 sq ft of well presented living space with the advantage of a private balcony and residents parking. This apartment also has no chain.

Fairmile House forms part of 'The Wharf' development, and is situated on the riverside and less than one mile from Teddington mainline station with the fashionable shops and restaurants of the High Street closer to hand.

- Two Double Bedrooms • Large Reception • Fitted Kitchen •
- Two Bathrooms • Balcony • Residents Parking •

SNELLERS

ESTATE AGENTS

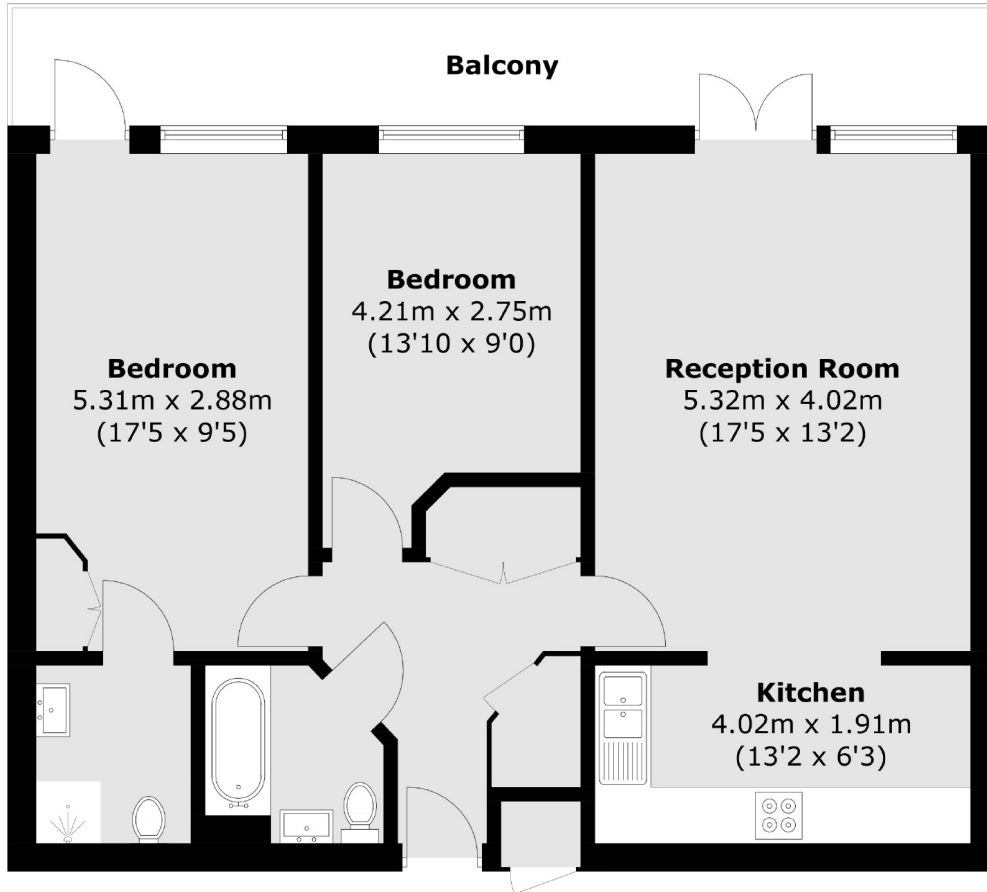

First Floor

Total area (approx.): 72.9 sq. m (784.7 sq. ft)
External Store (approx.): 0.6 sq. m (6.4 sq. ft)
Balcony area (approx.): 13.1 sq. m (141.0 sq. ft)

Snellers Teddington Sales
74 Broad Street
Teddington
TW11 8QX
020 8408 8040
teddingtonsales@snellers.co.uk

Energy Rating: C We aim to make our particulars both accurate and reliable. However they are not guaranteed; nor do they form part of an offer or contract. If you require clarification on any points then please contact us, especially if you're traveling some distance to view. Please note that appliances and heating systems have not been tested and therefore no warranties can be given as to their good working order