



Spring Grove Road, TW7
£779,995

Dexters



Spring Grove Road, TW7

A rare double-fronted 1930s house on a substantial corner plot on sought-after Spring Grove Road, boasting a striking facade, beautiful wrap-around garden extending to the rear, garage, and private driveway. This elegant three-bedroom, two bathroom semi-detached home, thoroughly renovated just over ten years ago, offers period charm, generous proportions, and exciting potential to extend (STPP). The property showcases classic 1930s character - original fireplaces, bay windows, picture rails and high ceilings.

The ground floor offers a flexible layout - two bright double aspect reception rooms, separate kitchen, downstairs shower room, separate WC and ample storage, with potential to extend into the rear garden. There is smart central heating, underfloor on the ground floor, and additional modern wood burners in both reception rooms. Upstairs are three spacious bedrooms, one family bathroom and separate WC. The rear garden provides a wonderfully private outdoor retreat.

Spring Grove Road is close to excellent schools, parks and shops. Transport links close by include Osterley (Piccadilly line) station, and Isleworth overground to Waterloo. Richmond, Twickenham and Chiswick are a short bus ride away. There is easy road access to the A4 and M4.

Features

- Double Fronted Semi-Detached
- Three Bedrooms
- Two Bathrooms
- Garage/Driveway
- Period Feature & Charm
- No Chain







Spring Grove Road, Isleworth, TW7

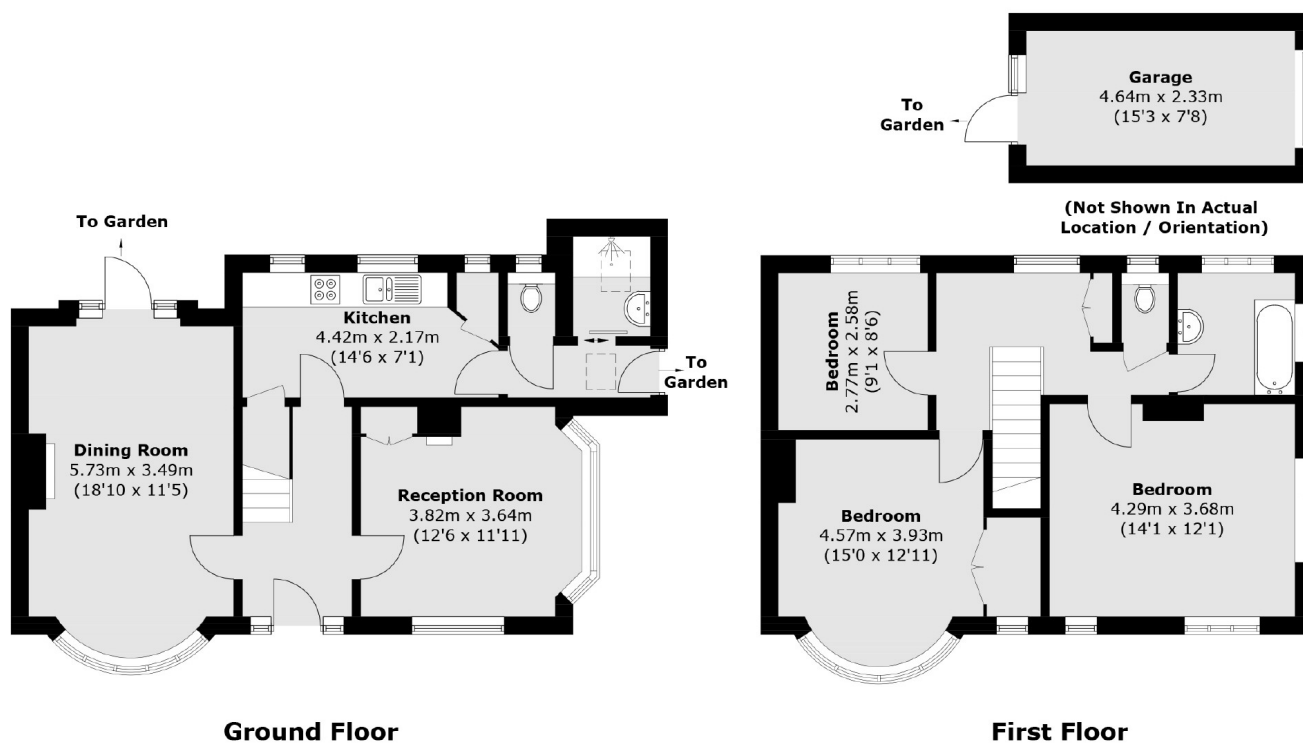

Total area (approx.): 112.7 sq. m (1,213.1 sq. ft)
Garage: 10.9 sq. m (117.3 sq. ft)