



## Unity Lane, TW3

### £345,000

A superbly spacious one double bedroom apartment within the exclusive High Street Quarter development. The property is situated on the upper floors and offers a private south facing balcony, long lease, and stunning communal gardens. Presented in beautiful condition, the property is ideal for first time buyers and investors alike.

Located moments from Hounslow East station (Piccadilly line) and the High Street with a variety of shops, bars and restaurants. There are excellent amenities nearby and easy access to the A4/M4 in and out of London.

### Features

- One Double Bedroom
- Private Large Balcony
- Underfloor Heating
- Long Lease
- Communal Gardens
- Close to Amenities
- Excellent Transport Links

# Unity Lane, Hounslow, TW3

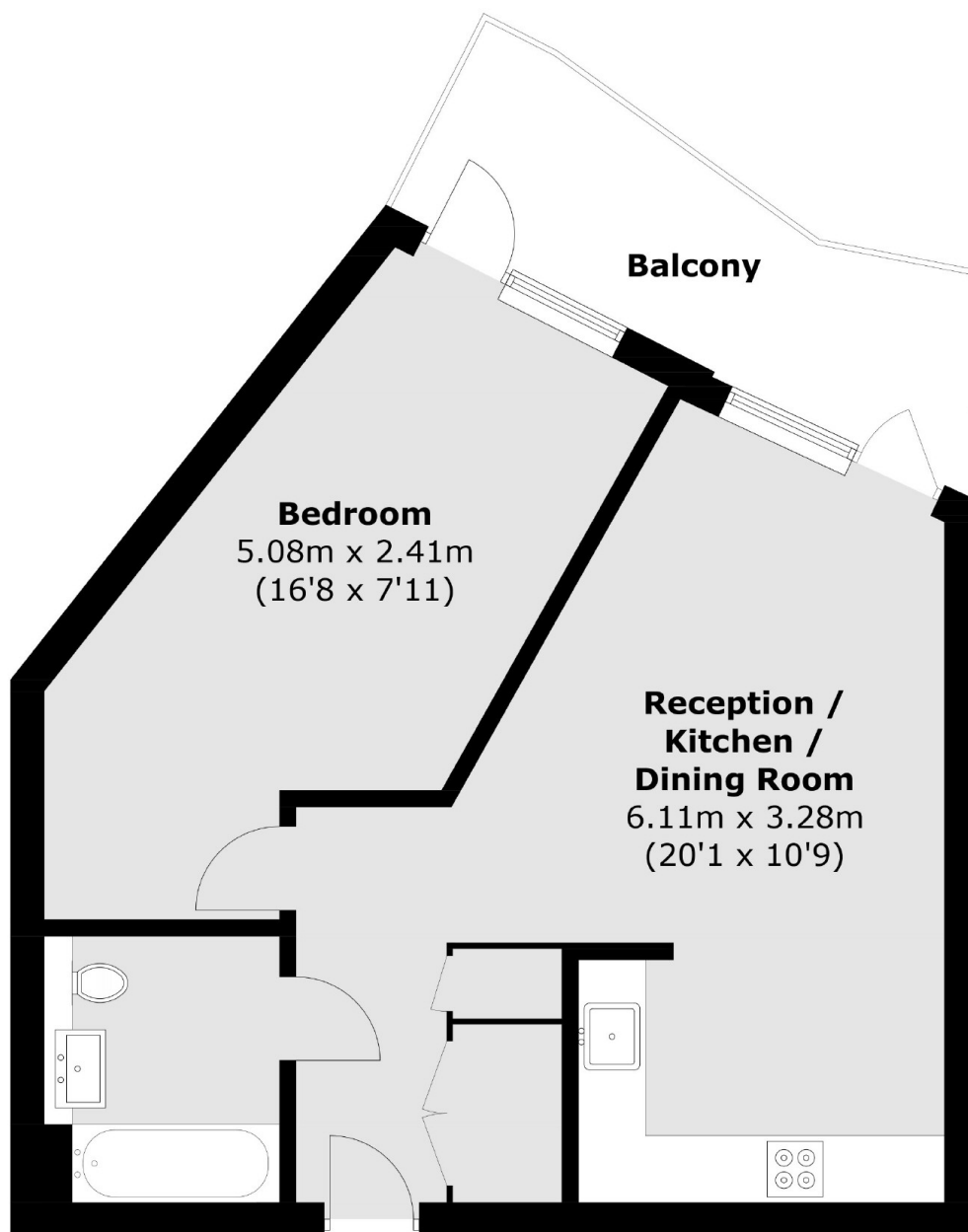

Total area (approx.): 57.1 sq. m (614.6 sq. ft)  
Balcony: 9.0 sq. m (96.9 sq. ft)

## Dexters

Isleworth  
568 London Road  
Isleworth  
TW7 4EP  
Sales  
020 8560 1177

Energy Rating: B. We aim to make our particulars both accurate and reliable. However they are not guaranteed; nor do they form part of an offer or contract. If you require clarification on any points then please contact us, especially if you're traveling some distance to view. Please note that appliances and heating systems have not been tested and therefore no warranties can be given as to their good working order.

 **RICS** | Regulated  
Estate Agent  
and Letting Agent

dexters.co.uk