



Loring Road, TW7

£825,000

This impressive four bedroom Victorian home on one of the most sought after roads in Isleworth. Offering more than 1,500 square feet of generous living space, the current owners have spared no expense having undertaken an impressive ground floor rear extension, in addition to high quality renovations throughout, whilst delicately preserving a wealth of period character and charm.

Loring Road is ideally located and one of Isleworth's most popular roads. Isleworth mainline station is a short walk away and has frequent train service to London Waterloo. There are a number of local schools, parks and amenities making it an ideal location for families

Features

End of Terrace House
Four Bedrooms
Two Bathrooms
Utility Room & WC
Immaculately Presented
Sought After Road



Loring Road, TW7

As you enter you're welcomed by an impressive entrance hallway leading to a stunning bay fronted reception room with eye-catching plantation shutters and wood panelling throughout. We love the dining space in the centre of the house which creates a wow-factor space when entertaining family and friends. To the rear there is an impressive large kitchen/reception with bi-fold doors spilling onto a private secluded garden with outbuilding at the end. There is also a handy utility room and downstairs WC. On the first floor there are two bright and spacious bedrooms, quirky office space and an elegant family bathroom with shower and bathtub. The loft has been cleverly extended optimising the space to accommodate two good size bedrooms and a further bathroom.



Loring Road, Isleworth, TW7

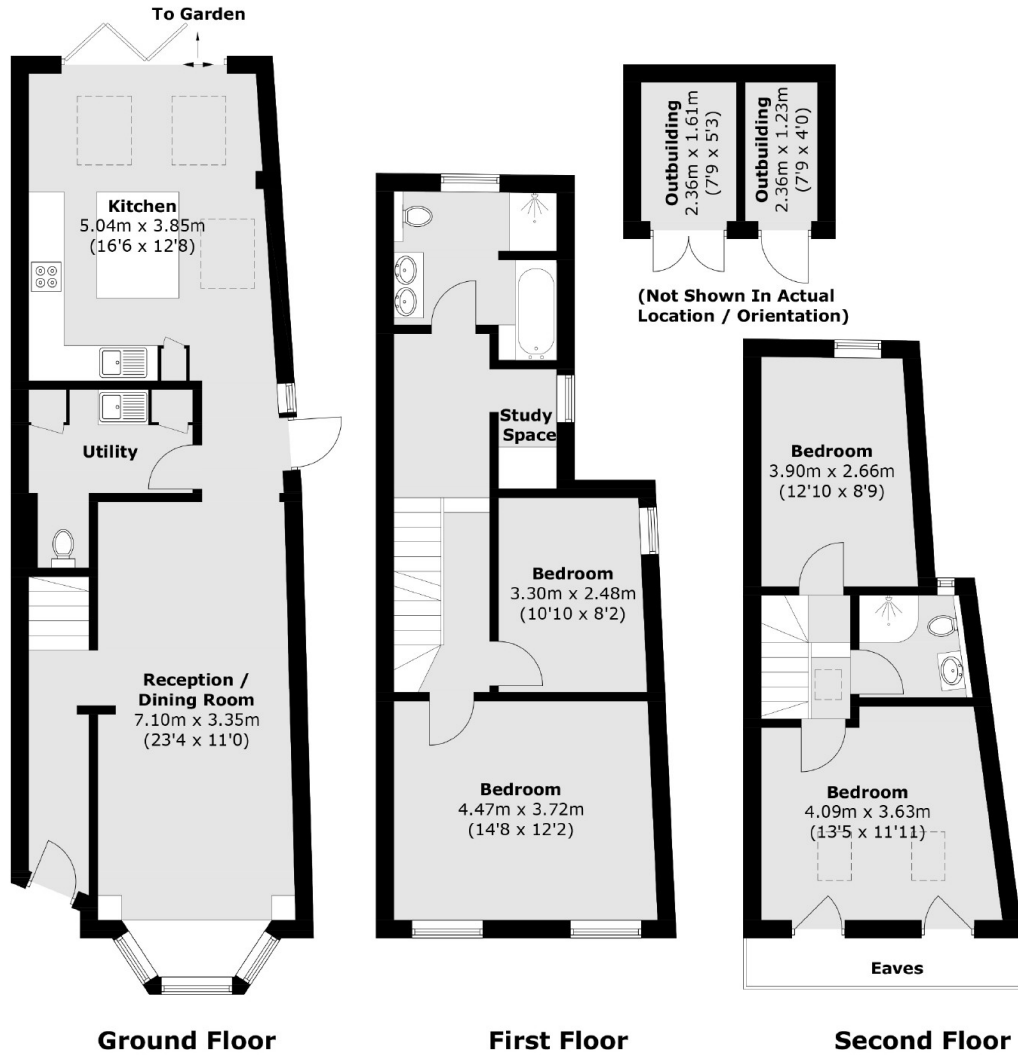

Total area (approx.): 137.3 sq. m (1,477.9 sq. ft)
Outbuilding area (approx.): 7.0 sq. m (75.3 sq. ft)

Dexters

Isleworth
568 London Road
Isleworth
TW7 4EP
Sales
020 8560 1177

Energy Rating: C. We aim to make our particulars both accurate and reliable. However they are not guaranteed; nor do they form part of an offer or contract. If you require clarification on any points then please contact us, especially if you're traveling some distance to view. Please note that appliances and heating systems have not been tested and therefore no warranties can be given as to their good working order.

RICS Regulated
Estate Agent
and Letting Agent

dexters.co.uk