



Lanadron Close, TW7

£329,950

A beautifully presented two double bedroom, one bathroom apartment within a popular residential development moments from Isleworth train station. The property benefits from ample storage, lift service and communal gardens. Offered to the market with no onward chain.

Beecher Court is situated in the heart of Isleworth and offers easy access to Isleworth mainline station, with excellent parks, schools and shops nearby.

Features

- Two Bedrooms
- Long Lease
- Popular Location
- Close to Train Station
- Ample Storage
- Integrated Appliances

Lanadron Close, Isleworth, TW7

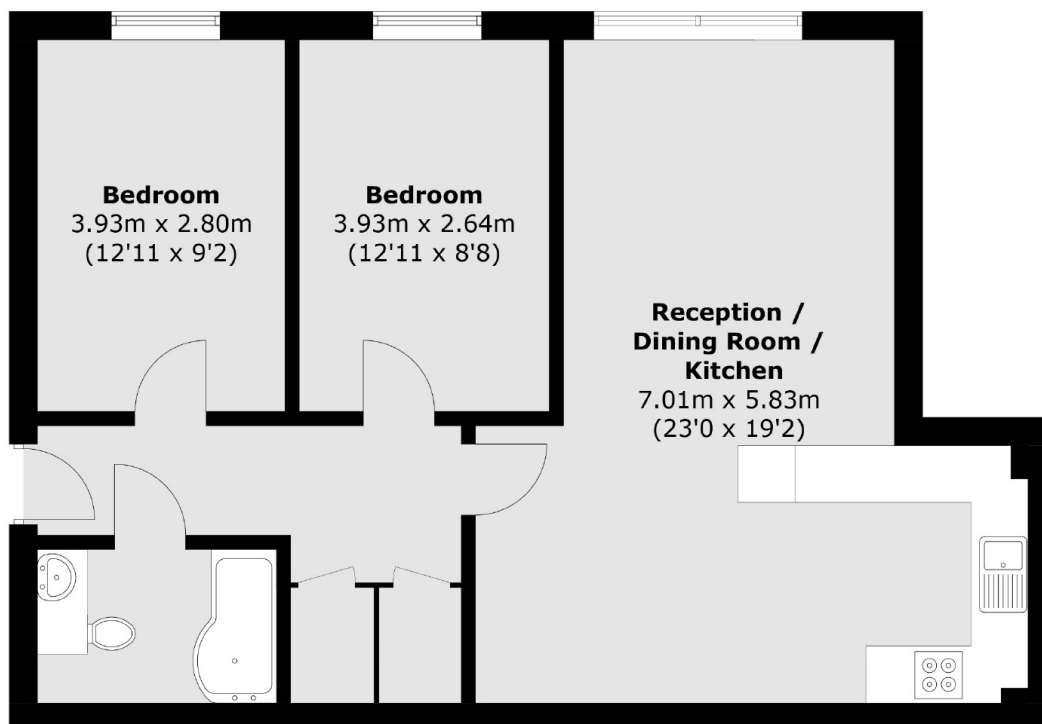

Total area (approx.): 67.3 sq. m (724.4 sq. ft)

Dexters

Isleworth
568 London Road
Isleworth
TW7 4EP
Sales
020 8560 1177

Energy Rating: . We aim to make our particulars both accurate and reliable. However they are not guaranteed; nor do they form part of an offer or contract. If you require clarification on any points then please contact us, especially if you're traveling some distance to view. Please note that appliances and heating systems have not been tested and therefore no warranties can be given as to their good working order.

 **RICS** | Regulated
Estate Agent
and Letting Agent

[dexters.co.uk](https://www.dexters.co.uk)