

Samuelson Place, TW7

£469,950

A simply stunning and spacious two double bedroom top floor apartment with a beautiful private balcony. The property is situated in an exclusive and sought after development with benefits including allocated parking, ample storage and a long lease. Ideal for first time buyers and investors alike.

Superbly situated in the heart of Isleworth, close to local amenities, parks and schools. Both Osterley (Piccadilly line) and Isleworth (mainline) stations are nearby with excellent transport links.

Features

- Beautifully Presented
- Top Floor Flat
- Two Double Bedrooms
- Private Balcony
- Allocated Parking
- Close To Transport Links

Samuelson Place, Isleworth, TW7

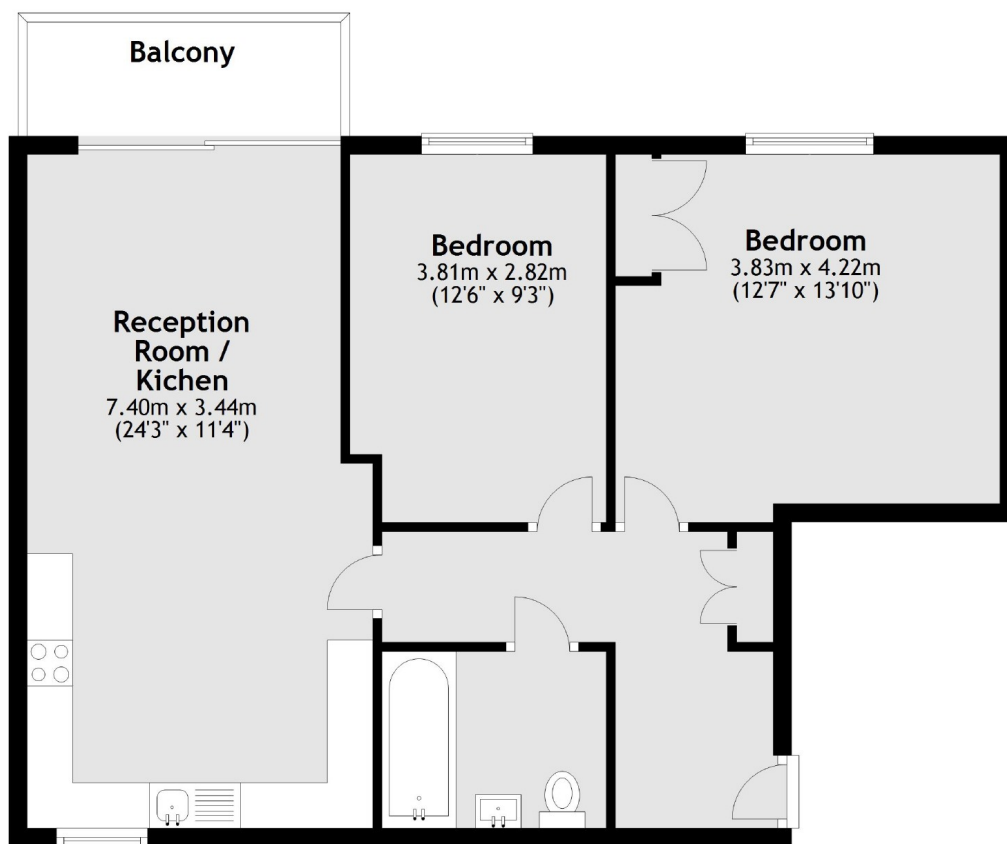

Total area: approx. 70.1 sq. metres (755.1 sq. feet)

Dexters

Isleworth
568 London Road
Isleworth
TW7 4EP
Sales
020 8560 1177

Energy Rating: B. We aim to make our particulars both accurate and reliable. However they are not guaranteed; nor do they form part of an offer or contract. If you require clarification on any points then please contact us, especially if you're traveling some distance to view. Please note that appliances and heating systems have not been tested and therefore no warranties can be given as to their good working order.

 **RICS** | Regulated
Estate Agent
and Letting Agent

[dexters.co.uk](https://www.dexters.co.uk)