



## Perkin Close, TW3

### £315,000

Offered to the market with no onward chain, is this delightful two double bedroom first floor apartment located in a popular and well maintained development. Further benefits include a separate kitchen, an allocated parking space and a long lease, making this property an ideal purchase for a first time buyer or investor.

Perkin Close is a quiet and peaceful development conveniently situated with Hounslow Central (Piccadilly Line) and Hounslow Mainline trains within walking distance. There are a vast array of shops, amenities and parks close by in addition to a number of excellent schools.

### Features

- First Floor Apartment
- Two Double Bedrooms
- Allocated Parking Space
- Communal Gardens
- Long Lease
- No Chain

# Perkin Close, Hounslow, TW3

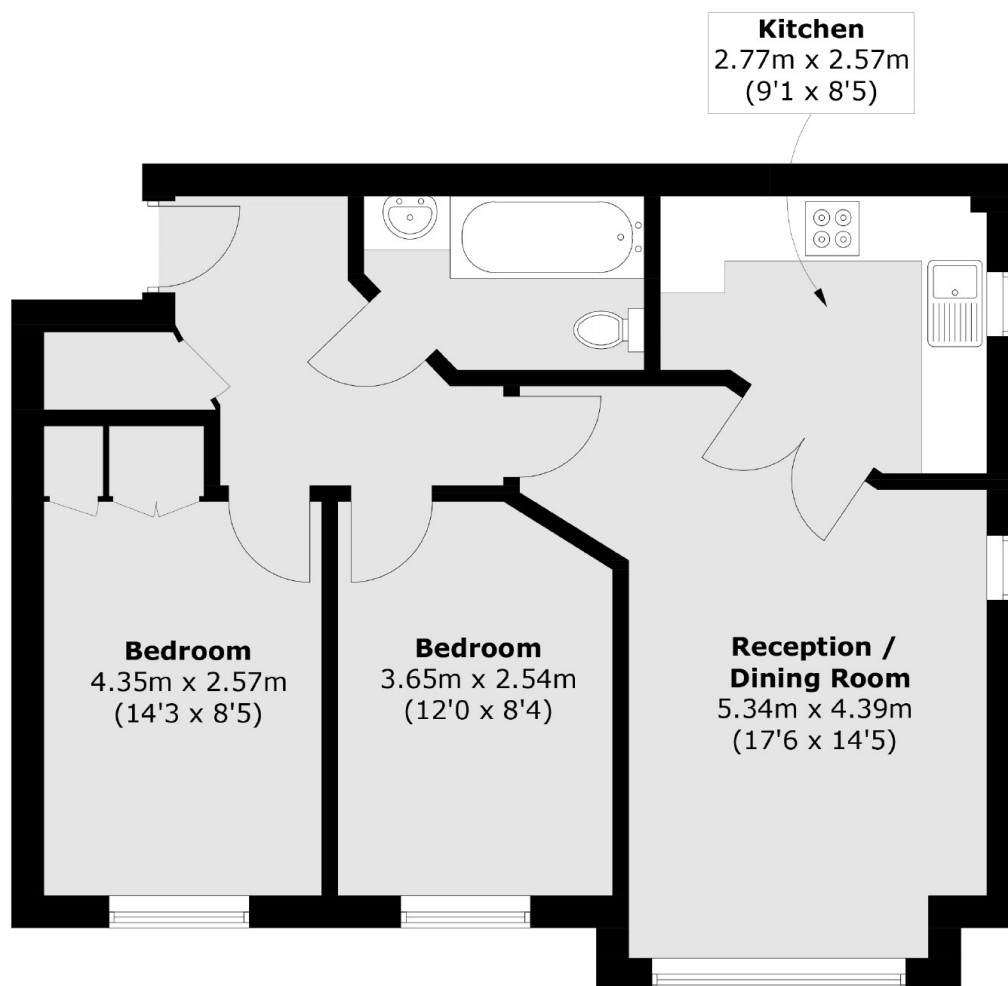

Total area (approx.): 56.7 sq. m (610.3 sq. ft)

## Dexters

Isleworth  
568 London Road  
Isleworth  
TW7 4EP  
Sales  
020 8560 1177

Energy Rating: . We aim to make our particulars both accurate and reliable. However they are not guaranteed; nor do they form part of an offer or contract. If you require clarification on any points then please contact us, especially if you're traveling some distance to view. Please note that appliances and heating systems have not been tested and therefore no warranties can be given as to their good working order.

 **RICS** | Regulated  
Estate Agent  
and Letting Agent

dexters.co.uk