



Kilberry Close, TW7

£299,995

Offered to the market with no onward chain is delightfully light, spacious and immaculately presented one double bedroom top floor apartment located within a sought after development in the heart of Isleworth.

Kilberry Close is a popular and sought after development located off Thornbury Road and provides easy access to Isleworth BR Mainline Station & Hounslow East/Osterley Tube Stations. St Margaret's and Twickenham are also within easy reach.

Features

- Top Floor Apartment
- One Double Bedroom
- Separate Kitchen
- Sought After Development
- Low Service Charge
- No Chain

Kilberry Close, Isleworth, TW7

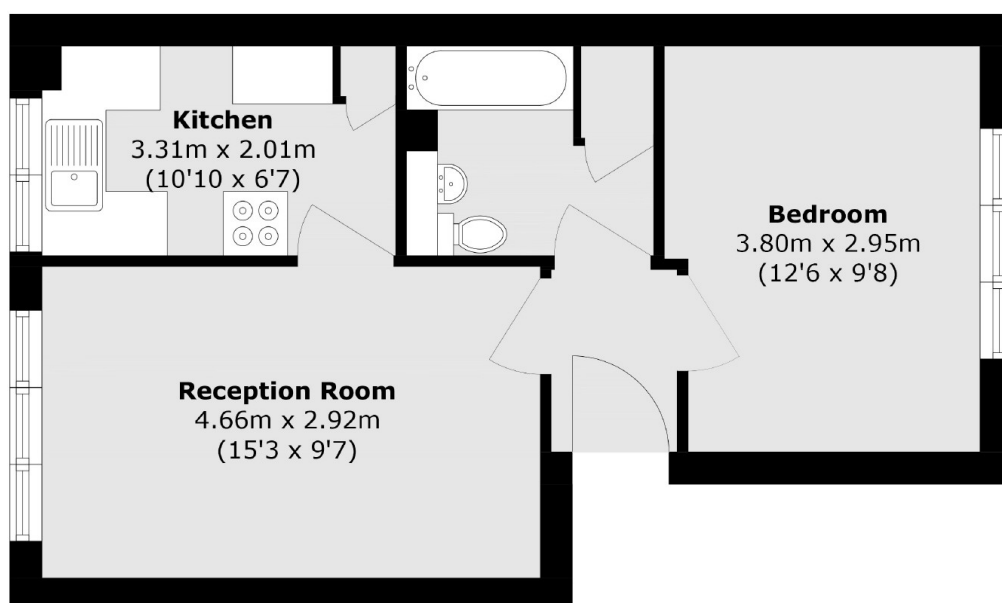

Total area (approx.): 38.8 sq. m (417.6 sq. ft)