



## Newcombe Gardens, TW4

### £325,000

Offered to the market with no onward chain is this spacious two double bedroom top floor apartment located on a quiet residential road / development. Benefits include a separate kitchen, long lease and allocated parking.

Newcombe Gardens is a quiet residential road within close proximity to Heathlands School (Outstanding Ofsted rated), local transport links and Hounslow town centre. There is also easy access to Whitton, Twickenham and Isleworth.

### Features

- Top Floor Apartment
- Two Double Bedrooms
- Allocated Parking
- Long Lease
- Popular Development

# Newcombe Gardens, Hounslow, TW4

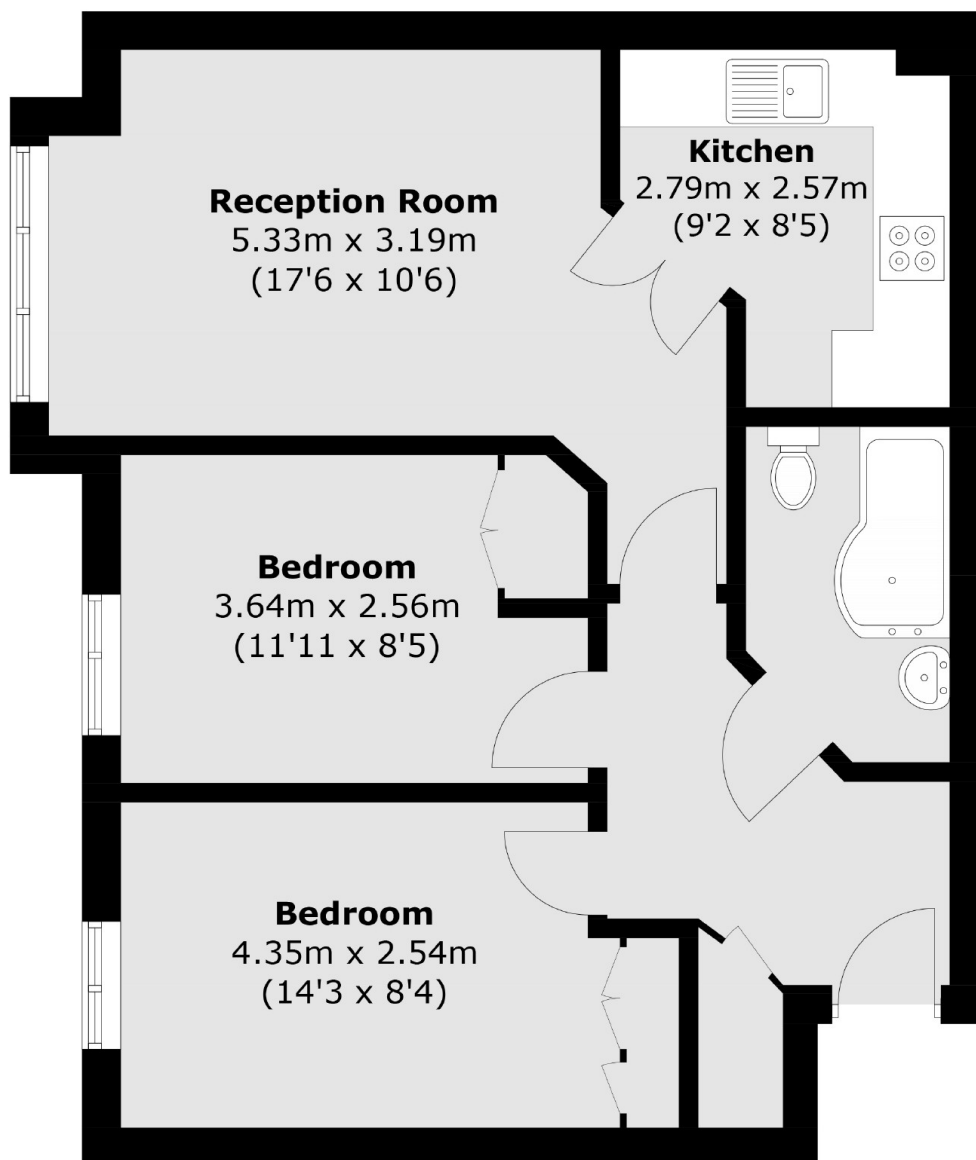

Total area (approx.): 54.3 sq. m (584.5 sq. ft)

## Dexters

Isleworth  
568 London Road  
Isleworth  
TW7 4EP  
Sales  
020 8560 1177

Energy Rating: E. We aim to make our particulars both accurate and reliable. However they are not guaranteed; nor do they form part of an offer or contract. If you require clarification on any points then please contact us, especially if you're traveling some distance to view. Please note that appliances and heating systems have not been tested and therefore no warranties can be given as to their good working order.

 **RICS** | Regulated  
Estate Agent  
and Letting Agent

[dexters.co.uk](https://www.dexters.co.uk)