



## Hexham Gardens, TW7

### £435,000

Offered to the market with no onward chain is this delightful and immaculately presented first floor maisonette set on the popular Duke Of Northumberland Estate. The property offers excellent room proportions, two double bedrooms, additional third bedroom/study, separate kitchen and large reception room. Further benefits include a loft space, a large private rear garden and a long lease in excess of 930 years.

Hexham Gardens is situated close to both Syon Lane train station and Osterley station (Piccadilly Line). There are a number of excellent local parks and amenities

### Features

- First Floor Maisonette
- Private Entrance
- Three Bedrooms
- Private Rear Garden
- Share of Freehold
- No Onward Chain

# Hexham Gardens, Isleworth, TW7

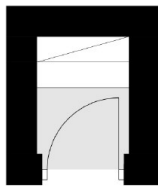

## Ground Floor

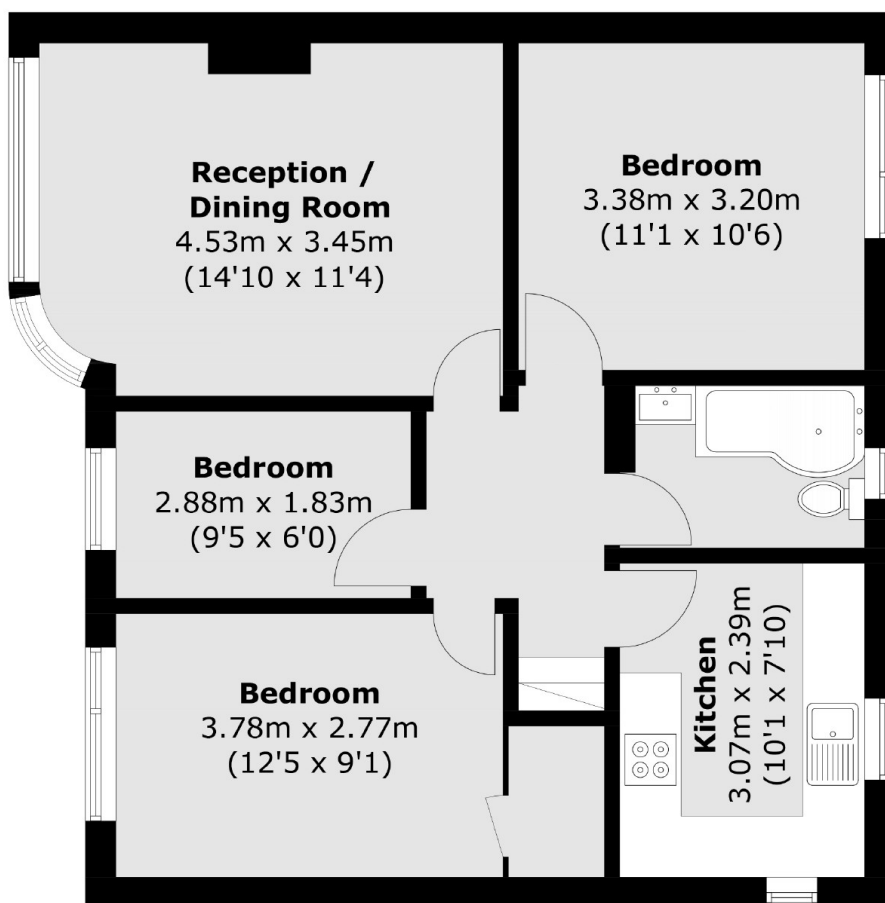

## First Floor

Total area (approx.): 62.9 sq. m (677.0 sq. ft)