



The Brooklands, TW7

£365,000

Offered to the market with no onward chain is this spacious two double bedroom ground floor maisonette set within a highly desirable development in Isleworth. Benefits include a separate kitchen with direct access to the communal gardens, reception room and well proportioned rooms. The current owners are undertaking a lease extension as part of the sale, making this a great purchase for first-time buyers or investors.

Eversley Crescent is well placed for easy access to Isleworth BR Mainline station, Osterley Tube & Hounslow East tube (Piccadilly Line). The shops and amenities of Isleworth are within walking distance and St Margaret's & Richmond town centres are also close by.

Features

- Ground Floor Apartment
- Two Bedrooms
- Separate Kitchen
- Access to Communal Gardens
- Sold with Extended Lease
- No Chain

The Brooklands, Isleworth, TW7

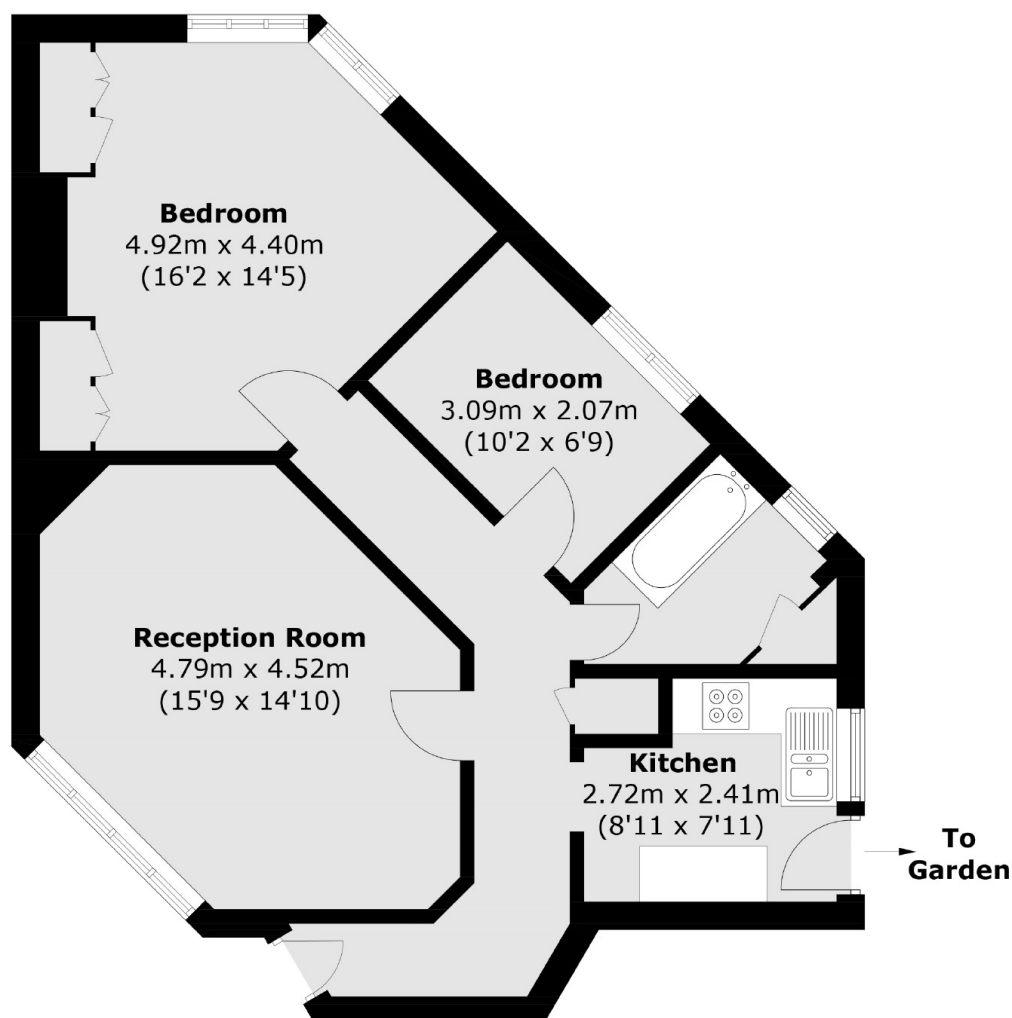

Total area (approx.): 64.6 sq. m (695.3 sq. ft)

Dexters

Isleworth
568 London Road
Isleworth
TW7 4EP
Sales
020 8560 1177

Energy Rating: . We aim to make our particulars both accurate and reliable. However they are not guaranteed; nor do they form part of an offer or contract. If you require clarification on any points then please contact us, especially if you're traveling some distance to view. Please note that appliances and heating systems have not been tested and therefore no warranties can be given as to their good working order.

 **RICS** | Regulated
Estate Agent
and Letting Agent

dexters.co.uk