



Newcombe Gardens, TW4

£325,000

Offered to the market with no onward chain is this immaculately presented and spacious two double bedroom ground floor apartment located on a quiet residential road / development. Benefits include a separate kitchen, long lease and allocated parking.

Newcombe Gardens is a quiet residential road within close proximity to Heathlands School (Outstanding Ofstead rated), local transport links and Hounslow town centre. There is also easy access to Whitton, Twickenham and Isleworth.

Features

- Ground Floor Apartment
- Two Double Bedrooms
- Immaculate Condition
- Allocated Parking
- Long Lease
- No Chain / Vacant

Newcombe Gardens, Hounslow, TW4

Ground Floor

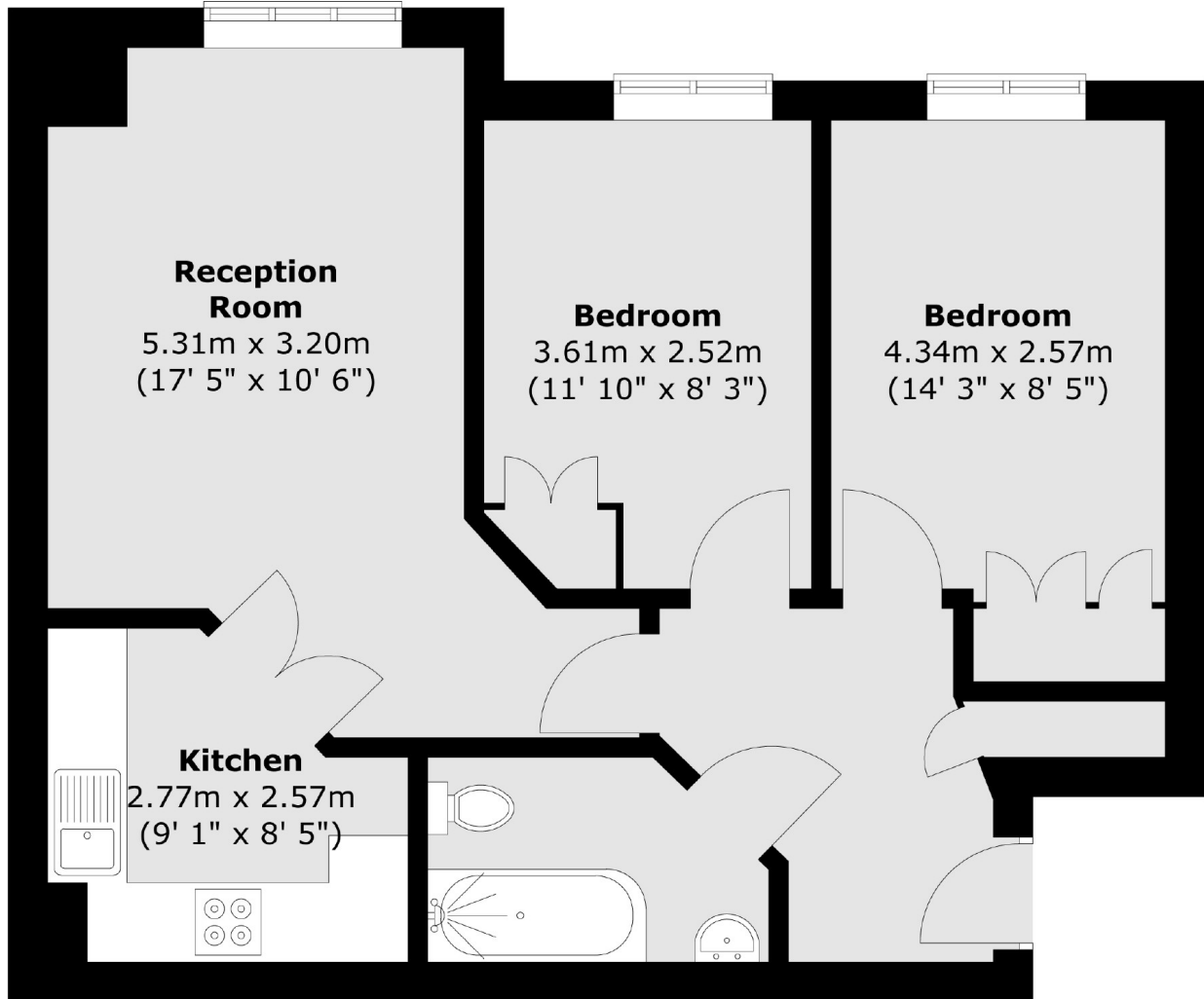

Total area (approx.) : 55.5 sq. m (597 sq. ft)