



The Grove, TW7

£329,950

Immaculately presented throughout is this light and spacious one double bedroom apartment in a sought after located within a gated development. Further benefits include a parking space and long lease.

The development is equidistant to Osterley tube station (Piccadilly line) and Isleworth train station, great road links to and from Central London as well as a short walk to local amenities, including a National Trust Park and excellent schools.

Features

- One Double Bedroom
- Gated Development
- Allocated Parking
- Long Lease
- Immaculate Condition
- Sought After Location

The Grove, Isleworth, TW7

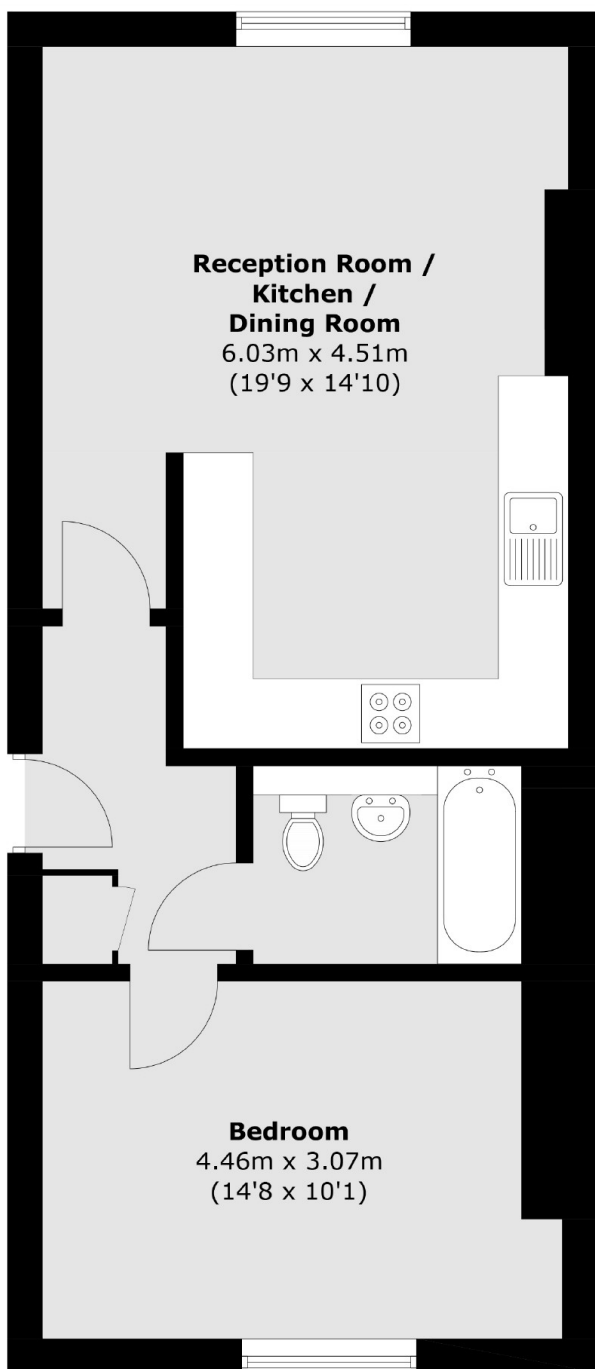

Total area (approx.): 49.9 sq. m (537.1 sq. ft)

Dexters

Isleworth
568 London Road
Isleworth
TW7 4EP
Sales
020 8560 1177

Energy Rating: . We aim to make our particulars both accurate and reliable. However they are not guaranteed; nor do they form part of an offer or contract. If you require clarification on any points then please contact us, especially if you're traveling some distance to view. Please note that appliances and heating systems have not been tested and therefore no warranties can be given as to their good working order.

 **RICS** | Regulated
Estate Agent
and Letting Agent

[dexters.co.uk](https://www.dexters.co.uk)